

CONTRACTOR IDENTIFICATION



Marking Services Incorporated

www.markserv.com | sales@markserv.com | (800)-234-0135

MSI CORE PHILOSOPHY

Logical, thorough and consistent communication is imperative for the safe and reliable operation of commercial and process facilities. At MSI, we want to help you establish guidelines and specifications to communicate meaningful information to facility personnel in support of safe operations, emergency response and compliance with regulatory requirements through an effective and durable plant labeling system. MSI wants your facility to be set up with “best practices” for plant labeling products, services and instant access to critical asset information using mobile technology.

Durable labeling installed properly and effectively is intended to support process safety management and uninterrupted production by providing critical information to plant personnel in a standardized and consistent manner. The objectives of asset management and identification from MSI are designed to deliver the following benefits:

1) **Process Safety Management (PSM):** PSM is an integral part of safe, reliable and effective plant operations. Benefits of enhancing a PSM program with respect to labeling include:

- Enhanced facility safety & productivity
- Improved operator training
- Assistance for maintenance personnel by providing instant access to asset information like operation and maintenance manuals and work procedures direct at the asset
- Reduced risk of equipment downtime
- Aid and support for emergency response personnel

2) **Hazard Reduction and the Prevention of Human Error:** A comprehensive and effective labeling program contributes to the effective functioning of process operations and limits the potential for downtime or injuries due to operations or maintenance errors.

3) **Uniformity of Labeling Nomenclature:** A labeling program that is standardized and consistent contributes to the flow of information and feedback among all affected departments including: operations, maintenance, safety, environmental, quality, administration, supply and management. Information flow regarding piping, equipment, valves, instrumentation and hazards shall be understood by all parties because of the standard definitions and specific identification included on each label, sign or tag.

4) **Regulatory Compliance:** Industries subject to government oversight or compliance testing can store critical data directly at the asset location and retrieve this data during inspections. Using mobile technology critical information can be retrieved at the asset without having to dig for information in engineering libraries.



MSI VALUE PROPOSITION

MSI is with you before, during and after a facility is constructed.

From scoping the project to labeling the assets, we're there to help make sure your facility is as safe and efficient as possible.



Budget Estimating

We can work with you to take your drawings and other documents and come up with a budget that best suits your needs.



Submittals

As a service to you, we will prepare pipe marker, valve tag and equipment label submittal documents that will meet your requirements. Give us your spec; we'll prepare a detailed submittal package that includes custom or stock mechanical identification and equipment labeling products, technical data sheets and samples.

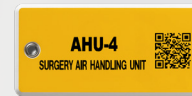

Custom Products

We offer identification labels and equipment tags customized specifically for your facility. Whereas other label makers only allow for minimum information, our unique manufacturing processes allow for a higher level of detail to ensure that you're receiving exactly what you're looking for.



Special Packaging

Making labeling a cost-effective part of your business entails managing installation expenses. To help reduce in-place costs, we offer special packaging services for your identification label order at no additional expense. We will sort and package materials in any way you'd like to ensure that your labeling process is as streamlined as possible.

Contact us to find out how we can help you with your project!





Want more information? Visit our website to see our full assortment of products and services.

www.markserv.com

Contents

1 | Pipe Markers

- 1. MS-970 Pipe Markers
- 3. MS-900 Pipe Markers
- 5. MS-995 Pipe Markers
- 7. MS-995 Carrier Pipe Markers
- 8. MS-995 Mounting Options
- 9. Small Bore & Medical Gas Markers
- 10. Duct Markers
- 11. MS-900 Economy Markers
- 12. Roll Markers
- 13. Mini Markers
- 14. Stencils & Locator Tacks

15 | Tapes

- 15. Banding Tape
- 15. Directional Arrow Tape
- 16. Underground Warning Tape

17 | Tags

- 18. MS-215 Tags
- 19. Engraved Plastic Tags
- 20. Brass Tags
- 20. Aluminum Tags
- 20. Stainless Steel Tags
- 21. Accident Prevention Tags
- 23. Specialty Tags

24 | Signs

- 25. Stainless Steel Signs
- 25. Custom MS-215 Max-Tek Signs
- 26. Aluminum Signs
- 26. Engraved Plastic Signs
- 27. Evacuation & Escape Signs
- 29. Safety/Operational Signs
- 30. GHS Signs
- 31. OSHA Right-to-Know Signs

32 | Mounting Options & Accessories

34 | Electrical Identification

- 34. Switch Plates
- 34. Wire Markers
- 35. Cable & Conduit Markers
- 37. Arc Flash Labels
- 37. Control Panel Labels

38 | Fire Identification

- 38. Fire ID Pipe Markers
- 38. Fire Damper & Access Door Markers
- 39. Fire ID Tags & Signs

40 | Ammonia Identification

- 41. Ammonia Pipe Markers
- 43. Ammonia Tags & Signage

Pipe Markers

MSI offers three main choices of pipe marking materials, each designed for use in a specific environment.

1 MS-970 Semi-Rigid Coiled Pipe Markers

Recommended for indoor use on dirty, oily or existing piping systems, especially where surface preparations for adhesive markers would require substantial labor costs. MS-970 markers are simply wound or snapped into place around piping, allowing for quick application without adhesives.

2 MS-900 Self-Adhesive Markers and Tapes

Recommended for newly installed piping in indoor environments that are not exposed to sunlight or harsh environmental conditions. After the backing is removed, these markers may simply be applied directly to the pipe.

3 MS-995 Maxilar Markers

Recommended for use in applications involving process chemicals, food processing, pharmaceuticals, water treatment facilities and marine and offshore environments. These markers are made of materials that offers proven durability on outdoor piping systems exposed to sunlight, chemicals and other harsh environmental conditions.

Our pipe identification labels provide a quick, accurate snapshot of critical information such as pipe content, flow direction, origin and destination. Proper pipe labeling eliminates the need to trace lines and promotes a greater understanding of piping layouts, translating to a quicker commissioning of a new building or facility upgrade.



MS-970 Coiled Pipe Markers

For indoor environments where high heat and harsh chemicals are not present.

MS-970 coiled pipe markers are constructed of semi-rigid material and are designed to identify piping in a wide variety of environments, especially in applications where the pipe surface is rough, oily, or wet. They stay in place on pipes due to the memory of the coiling process, and therefore do not rely on adhesives. Complies with ASME A13.1

Features

- Coiled construction quickly snaps around pipes
- Ideal for dirty or sweating pipes where adhesives cannot be used
- No pipe surface preparation needed
- Self-locking adhesive strip keeps marker in place even on vertical pipes
- Plastic nylon straps are included to secure marker in place on pipes 6" or larger
- Can be removed and reused
- Service temperature range: -40°F to 160°F
- Flow direction arrows are printed on each marker
- Standard background colors: Yellow, Green, Red, Blue, White, Orange
- Standard copy colors: White, Black
- ASME A13.1-1996 colors available

Customized MS-970 Pipe Markers

- No setup charges
- No minimum order quantity
- Include any combination of the following items to make up the marker legend: Pipe contents, origin (from) and destination (to), line numbers, equipment numbers, and flow direction
- Multiple color combinations available
- Custom sizes and colors available

Pipe Diameter (Including Insulation)	Marker Style	Marker Width	Character Height	Marker Type
3/8" - 1/2"	TM	3"	1/4"	coil-on
1/2" - 1"	A	8"	1/2"	coil-on
1 1/8" - 2 1/4"	B	8"	3/4"	coil-on
2 3/8" - 3 1/4"	C	12"	1 1/4"	coil-on
3 3/8" - 4 1/2"	D	12"	1 1/4"	coil-on
4 5/8" - 5 7/8"	E	12"	1 1/4"	coil-on
6" - 7 7/8"	F	12"	1 1/4"	strap-on
8" - 10"	G	24"	2 1/2"	strap-on
over 10"	H	32"	3 1/2"	strap-on

- Style F Markers include two 36" nylon straps
- Style G Markers include three 36" nylon straps
- Style H Markers include three 48" nylon straps
- * Additional straps available if needed



ORDER MS-970 Pipe Markers

- Determine the four-digit part number for each legend.
- Use the marker style table at the bottom right corner of page 3 to determine size of marker desired.
- EXAMPLE: The marker "ACID" for a 2" diameter pipe would be part number 9800B
- Contact us for custom markers

Legend	Color	Part #	Legend	Color	Part #	Legend	Color	Part #
ACID	ORG	9800	FIRE PROTECTION WATER	RED	9826	OXYGEN	ORG	9690
ACID VENT	ORG	9641	FIRE SPRINKLER WATER	RED	9736	PLANT AIR	BLU	9691
ACID WASTE	ORG	9642	FREON	ORG	9664	POLYMER SOLUTION	YEL	9743
AIR	BLU	9875	FUEL GAS	YEL	9886	POTABLE WATER	GRN	9848
ALUM	YEL	9876	FUEL OIL	YEL	9828	PROCESS WATER	GRN	9853
AMMONIA	ORG	9643	FUEL OIL RETURN	YEL	9737	PROCESS WATER RETURN	GRN	9703
ARGON	ORG	9644	FUEL OIL SUPPLY	YEL	9738	PROCESS WATER SUPPLY	GRN	9704
ASBESTOS FREE INSULATION	BLU	9729	GAS	YEL	9829	PROPANE	YEL	9849
BOILER BLOWDOWN	GRN	9645	GLYCOL RETURN	ORG	9665	PUMPED CONDENSATE	GRN	9693
BOILER FEEDWATER	GRN	9646	GLYCOL SUPPLY	ORG	9666	RAW WATER	GRN	9850
BRINE	ORG	9647	HEATING HOT WATER RETURN	GRN	9667	REFRIGERANT LIQUID	YEL	9706
BYPASS	ORG	9648	HEATING HOT WATER SUPPLY	GRN	9668	REFRIGERANT SUCTION	YEL	9707
CARBON DIOXIDE	ORG	9649	HEATING RETURN	YEL	9832	RETURN	ORG	9722
CAUSTIC	ORG	9650	HEATING SUPPLY	YEL	9833	RETURN	GRN	9851
CHEMICAL FEED	ORG	9651	HEATING WATER RETURN	GRN	9669	ROOF DRAIN	GRN	9872
CHILLED WATER	GRN	9807	HEATING WATER SUPPLY	GRN	9670	SANITARY DRAIN	GRN	9708
CHILLED WATER RETURN	GRN	9808	HI PRESS CONDENSATE	GRN	9671	SANITARY SEWER	GRN	9709
CHILLED WATER SUPPLY	GRN	9809	HI PRESS GAS	YEL	9871	SANITARY VENT	BLU	9723
CHLORINE	ORG	9652	HI PRESS STEAM	GRN	9672	SANITARY WASTE	GRN	9755
CHLORINE SOLUTION	YEL	9731	HI PRESS STEAM	YEL	9835	SEAL WATER	GRN	9711
CIRCULATING WATER	GRN	9811	HOT WATER	GRN	9673	SERVICE AIR	YEL	9746
CITY WATER	GRN	9813	HOT WATER RETURN	GRN	9674	SOFT COLD WATER	GRN	9756
COLD WATER	GRN	9814	HOT WATER SUPPLY	GRN	9675	SOFT WATER	GRN	9712
COLD WATER RETURN	GRN	9866	HYDRAULIC OIL	YEL	9889	SPRINKLER WATER	RED	9854
COLD WATER SUPPLY	GRN	9867	HYDROCHLORIC ACID	YEL	9739	STEAM	GRN	9724
COMPRESSED AIR	YEL	9815	HYDROGEN	ORG	9676	STEAM CONDENSATE	GRN	9725
COMPRESSED AIR	BLU	9732	INDUSTRIAL COLD WATER	GRN	9891	STORM DRAIN	GRN	9873
CONDENSATE	GRN	9653	INDUSTRIAL HOT WATER	GRN	9677	STORM SEWER	GRN	9868
CONDENSATE DRAIN	GRN	9654	INSTRUMENT AIR	BLU	9892	STORM WATER	GRN	9714
CONDENSATE RETURN	GRN	9655	LAB AIR	ORG	9678	SULFURIC ACID	ORG	9726
CONDENSATE SUPPLY	GRN	9656	LAB VACUUM	ORG	9679	SUMP PUMP DISCHARGE	GRN	9744
CONDENSER WATER	GRN	9819	LAB WASTE	ORG	9680	SUPPLY	ORG	9747
CONDENSER WATER RETURN	GRN	9864	LO PRESS CONDENSATE	GRN	9681	SUPPLY	GRN	9856
CONDENSER WATER SUPPLY	GRN	9865	LO PRESS STEAM	GRN	9682	TEMPERED WATER	GRN	9757
COOLING WATER	GRN	9820	LO PRESS STEAM	YEL	9839	TOWER WATER RETURN	GRN	9749
COOLING WATER RETURN	GRN	9882	LUBE OIL	YEL	9896	TOWER WATER SUPPLY	GRN	9750
COOLING WATER SUPPLY	GRN	9883	MAKE UP WATER	GRN	9840	TREATED WATER	GRN	9874
DEIONIZED WATER	GRN	9821	MED PRESS CONDENSATE	GRN	9683	UTILITY WATER	YEL	9751
DOMESTIC COLD WATER	GRN	9822	MED PRESS STEAM	GRN	9684	VACUUM	PUR	9758
DOMESTIC COLD WATER RETURN	GRN	9770	MED PRESS STEAM	YEL	9841	VACUUM	ORG	9759
DOMESTIC COLD WATER SUPPLY	GRN	9771	MEDICAL AIR	BLU	9685	VENT	ORG	9760
DOMESTIC HOT WATER	GRN	9657	MEDICAL VACUUM	WHT	9753	VENT	BLU	9761
DOMESTIC HOT WATER RECIRC	GRN	9658	METHANOL	YEL	9898	WASTE	ORG	9762
DOMESTIC HOT WATER RETURN	GRN	9659	MILL AIR	BLU	9727	WASTEWATER	ORG	9763
DRAIN	ORG	9660	MILL WATER	GRN	9728	WATER	ORG	9764
DRAIN	GRN	9824	NATURAL GAS	YEL	9842	WATER	GRN	9860
DRAIN	YEL	9734	NITROGEN	ORG	9686	WELL WATER	GRN	9721
DRINKING WATER	GRN	9735	NITROUS OXIDE	ORG	9687			
DUAL TEMP RETURN	GRN	9661	NON POTABLE WATER	GRN	9688			
DUAL TEMP SUPPLY	GRN	9662	OIL	YEL	9845			
EXHAUST	BLU	9663	OVERFLOW	ORG	9689			
FILTERED WATER	GRN	9885	OXYGEN	BLU	9700			

PIPE MARKERS

MS-900

MS-900 Self-Adhesive Pipe Markers

For line service identification and system color coding.

- Complies with ASME A13.1
- Printed on premium quality, fade-resistant material
- Adheres well to pipe and insulation with only limited surface preparation
- Legend markers can be used with arrow tape or separate arrow markers to indicate flow direction (see page 15 for arrow tape)

Custom MS-900 Self-Adhesive Pipe Markers

- No set-up charges or minimum quantity requirement
- Custom colors available
- ASME A13.1-1996 colors available

Marker Style	Pipe Diameter (Including Insulation)	Marker Size	Character Height
A	¾" - 2¼"	1" x 8"	¾"
B	2½" - 7⅞"	2¼" x 13"	1¾"
C	8" - 10"	4" x 24"	2½"
D	Over 10"	4" x 32"	3½"

Note: Arrow markers are half the length of pipe markers.

HI PRESS RECEIVER

AIR

CHILLED WATER SUPPLY

Legend	Color	Style A	B	C	D
2 PSI GAS	YEL	91100	92100		
2 PSI NATURAL GAS	YEL	91545	92545		
ACETYLENE GAS	YEL	91101	92101		
120° HOT WATER	GRN	91226	92226		
140° HOT WATER	GRN	91227	92227		
160° HOT WATER	GRN	91228	92228		
ACID	ORG	91229	92229		
ACID VENT	ORG	91241	92241	93241	94241
ACID WASTE	ORG	91231	92231		
AIR	YEL	91103	92103		
AIR	BLU	91211	92211		
AMMONIA	ORG	91232	92232	93232	94232
ARGON	ORG	91233	92233		
ARROWS	BLK	91205	92205	93205	94205
ARROWS	BRN	91206	92206	93206	94206
ARROWS	GRY	91207	92207	93207	94207
ARROWS	ORG	91223	92223	93223	94223
ARROWS	PUR	91224	92224	93224	94224
ARROWS	WHT	91225	92225	93225	94225
ASBESTOS FREE INSULATION	BLU	91107	92107		
BOILER BLOWDOWN	GRN	91234	92234		
BOILER FEED	GRN	91235	92235		
BOILER FEEDWATER	GRN	91237	92237	93237	94237
BREATHING AIR	BLU	91401	92401		
CARBON DIOXIDE	ORG	91238	92238		
CAUSTIC	ORG	91239	92239		
CHEMICAL FEED	ORG	91242	92242		
CHILLED WATER	GRN	91114	92114	93114	94114
CHILLED WATER RETURN	GRN	91115	92115	93115	94115
CHILLED WATER SUPPLY	GRN	91116	92116	93116	94116
CHLORINE	ORG	91243	92243		
CHLORINE SOLUTION	ORG	91244	92244		
CIRCULATING WATER	GRN	91118	92118		
CITY WATER	GRN	91119	92119	93119	
CLEAN DRY AIR	BLU	91403	92403		
COLD WATER	GRN	91120	92120		
COLD WATER RETURN	GRN	91121	92121		
COLD WATER SUPPLY	GRN	91122	92122		
COMPRESSED AIR	YEL	91123	92123		
COMPRESSED AIR	BLU	91284	92284		
CONDENSATE	GRN	91245	92245	93245	94245
CONDENSATE DRAIN	GRN	91246	92246		
CONDENSATE RETURN	GRN	91247	92247	93247	94247
CONDENSER WATER	GRN	91128	92128	93128	94128
CONDENSER WATER RETURN	GRN	91129	92129	93129	94129
CONDENSER WATER SUPPLY	GRN	91130	92130	93130	94130
COOLING WATER	GRN	91131	92131	93131	
COOLING WATER RETURN	GRN	91286	92286		
COOLING WATER SUPPLY	GRN	91287	92287		
DEIONIZED WATER	GRN	91132	92132		
DEMINERALIZED WATER	GRN	91214	92214		
DIESEL	YEL	91304	92304		
DISCHARGE	ORG	91248	92248		
DOMESTIC COLD WATER	GRN	91136	92136	93136	
DOMESTIC HOT WATER	GRN	91249	92249	93249	
DOMESTIC HOT WATER RECIRC	GRN	91250	92250		
DOMESTIC HOT WATER RETURN	GRN	91251	92251		
DOMESTIC HOT WATER SUPPLY	GRN	91252	92252		
DOMESTIC WATER	GRN	91325	92325		

Legend	Color	Style A	B	C	D
DRAIN	ORG	91262	92262	93262	
DRAIN	GRN	91137	92137	93137	
DUAL TEMP RETURN	GRN	91263	92263		
DUAL TEMP SUPPLY	GRN	91264	92264		
EVACUATION VACUUM	PUR	91265	92265		
EVACUATION VACUUM	ORG	91268	92268		
EXHAUST	BLU	91269	92269		
EXHAUST AIR	BLU	91270	92270	93270	
FEEDWATER	GRN	91271	92271		
FILTERED WATER	GRN	91253	92253	93253	94253
FIRE PROTECTION WATER	RED	91142	92142	93142	
FIRE SPRINKLER WATER	RED	91143	92143		
FREON	GRN	91144	92144		
FUEL GAS	YEL	91145	92145		
FUEL OIL	YEL	91146	92146		
FUEL OIL RETURN	YEL	91332	92332		
FUEL OIL SUPPLY	YEL	91333	92333		
GAS	YEL	91147	92147		
GASOLINE	YEL	91148	92148		
GLYCOL	ORG	91273	92273	93273	94273
GLYCOL RETURN	ORG	91274	92274		
GLYCOL SUPPLY	ORG	91275	92275		
HALON	RED	91150	92150		
HEATING	YEL	91151	92151		
HEATING HOT WATER RETURN	GRN	91276	92276	93276	
HEATING HOT WATER SUPPLY	GRN	91277	92277	93277	
HEATING RETURN	YEL	91152	92152	93152	
HEATING SUPPLY	YEL	91153	92153	93153	
HEATING WATER RETURN	GRN	91278	92278	93278	
HEATING WATER SUPPLY	GRN	91279	92279	93279	
HI PRESS AIR	YEL	91154	92154		
HI PRESS AIR	BLU	91218	92218		
HI PRESS CONDENSATE	GRN	91280	92280	93280	94280
HI PRESS GAS	YEL	91155	92155		
HI PRESS STEAM	GRN	91307	92307	93307	94307
HOT GAS	YEL	91327	92327		
HOT WATER	GRN	91308	92308	93308	94308
HOT WATER RETURN	GRN	91311	92311	93311	94311
HOT WATER SUPPLY	GRN	91312	92312	93312	94312
HOUSE VACUUM	PUR	91309	92309	93309	
HYDRAULIC FLUID	YEL	91257	92257		
HYDROCHLORIC ACID	ORG	91313	92313		
HYDROGEN	ORG	91323	92323	93323	94323
HYDROGEN PEROXIDE	ORG	91324	92324		
HYDROGEN SULFIDE	YEL	91306	92306		
INDUSTRIAL COLD WATER	GRN	91295	92295		
INDUSTRIAL HOT WATER	GRN	91335	92335		
INDUSTRIAL WASTE	ORG	91336	92336		
INSTRUMENT AIR	GRN	91162	92162	93162	
INSTRUMENT AIR	BLU	91219	92219		
INSTRUMENT NITROGEN	BLU	91406	92406		
LO PRESS AIR	BLU	91339	92339		
LO PRESS CONDENSATE	GRN	91340	92340	93340	94340
LO PRESS GAS	YEL	91164	92164		
LO PRESS STEAM	GRN	91341	92341	93341	94341
LUBE OIL	YEL	91166	92166		
LUBE OIL RETURN	YEL	91407	92407		
LUBE OIL SUPPLY	YEL	91408	92408		
MAKE UP WATER	GRN	91167	92167		
MED PRESS CONDENSATE	GRN	91342	92342	93342	94342
MED PRESS STEAM	GRN	91343	92343	93343	94343
MEDICAL AIR	BLU	91344	92344		
MEDICAL VACUUM	WHT	91411	92411		
MILL AIR	BLU	91260	92260	93260	
MILL WATER	GRN	91261	92261	93261	94261
NATURAL GAS	YEL	91168	92168	93168	
NITROGEN	ORG	91345	92345		
NITROGEN	BLK	91169	92169		
NITROUS OXIDE	ORG	91346	92346		

Legend	Color	Style A	B	C	D
NON POTABLE WATER	GRN	91347	92347	93347	94347
OIL	YEL	91171	92171		
OIL FREE AIR	BLU	91413	92413		
OUTSIDE AIR	BLU	91329	92329	93329	
OXYGEN	BLU	91348	92348		
OXYGEN	ORG	91349	92349		
OXYGEN	GRN	91330	92330		
PLANT AIR	BLU	91350	92350		
PLANT WATER	GRN	91174	92174		
POTABLE WATER	GRN	91175	92175		
POTABLE COLD WATER	GRN	91414	92414		
POTABLE HOT WATER	GRN	91351	92351		
PROCESS WATER	YEL	91176	92176		
PROCESS WATER	GRN	91220	92220		
PROCESS COOLING WATER RETURN	GRN	91416	92416	93416	94416
PROCESS COOLING WATER SUPPLY	GRN	91417	92417	93417	94417
PROCESS VACUUM	ORG	91352	92352		
PROPANE GAS	YEL	91177	92177		
PUMPED CONDENSATE	GRN	91353	92353	93353	
RAINWATER	GRN	91419	92419		
RAW WATER	GRN	91178	92178	93178	94178
RECIRCULATING HOT WATER	GRN	91354	92354		
REFRIGERANT	YEL	91179	92179		
REFRIGERANT LIQUID	YEL	91180	92180		
REFRIGERANT SUCTION	YEL	91181	92181		
RELIEF AIR	BLU	91281	92281	93281	
RETURN AIR	BLU	91282	92282	93282	
RETURN	ORG	91355	92355	93355	
RETURN	GRN	91183	92183	93183	
ROOF DRAIN	GRN	91184	92184	93184	
SANITARY DRAIN	GRN	91236	92236	93236	
SANITARY SEWER	GRN	91185	92185	93185	
SANITARY VENT	BLU	91356	92356		
SANITARY WASTE	GRN	91298	92298		
SEAL WATER	GRN	91267	92267		
SERVICE AIR	BLU	91357	92357		
SLUDGE	ORG	91359	92359		
SODIUM HYDROXIDE	ORG	91360	92360		
SOFT WATER	GRN	91187	92187		
STEAM	GRN	91361	92361	93361	94361
STORM DRAIN	GRN	91299	92299	93299	
STORM SEWER	GRN	91300	92300	93300	
STORM WATER	GRN	91301	92301	93301	
SUCTION	ORG	91362	92362		
SULFURIC ACID	ORG	91364	92364		
SUMP PUMP DISCHARGE	GRN	91365	92365		
SUPPLY	ORG	91366	92366	93366	94366
SUPPLY	GRN	91193	92193	93193	94193
SUPPLY AIR	BLU	91283	92283	93283	
TEMPERED WATER	GRN	91367	92367		
TOLUENE	YEL	91194	92194		
TOWER WATER	GRN	91195	92195	93195	
TOWER WATER RETURN	GRN	91319	92319	93319	
TOWER WATER SUPPLY	GRN	91320	92320	93320	
TREATED WATER	GRN	91196	92196		
ULTRA PURE WATER	GRN	91420	92420		
UTILITY NITROGEN	GRN	91421	92421		
UTILITY WATER	GRN	91422	92422		
VACUUM	ORG	91371	92371	93371	94371
VACUUM	GRN	91197	92197	93197	
VENT	BLU	91372	92372	93372	
VENT	ORG	91373	92373	93373	94373
WAGD	PUR	91432	92432		
WASTE	ORG	91374	92374		
WASTE	YEL	91202	92202		
WASTE WATER	ORG	91375	92375	93375	94375
WATER	GRN	91203	92203	93203	
WATER	YEL	91204	92204	93204	
WELL WATER	GRN	91321	92321		



MS-995 Coiled Maxilar™ Markers

MS-995 pipe markers convey pertinent information taken from client P&IDs to the actual piping within the facility. MS-995 pipe markers are manufactured for extended life in harsh surroundings involving process chemicals, food processing, pharmaceuticals, water treatment, and marine and offshore environments. MS-995 markers are tested and produced to withstand prolonged exposure to direct sunlight, salt water, harsh process chemicals, acids, caustics and hydrocarbons.

- Pre-coiled markers install easily by wrapping entirely around the pipe diameter and self-sealing with a permanent lock down strip
- Installation can be on either bare or insulated pipe, and requires no surface preparation for attachment since they bond to themselves, not the pipe surface
- Ideal for chemical process plants, pharmaceutical plants, pulp and paper mills and upstream and downstream oil and gas facilities
- Can be removed and reinstalled
- ASME A13.1-1996 colors available

Custom MS-995 Maxilar™ Markers

Custom pipe markers available to meet plant specific needs for color, pipe diameter and information (including From/To, P&ID numbers, line numbers, pipe contents, flow direction, etc.)

Styles Available

Coiled MS-995 pipe markers are available in ten standard sizes to fit pipes with overall **outside** diameters of ⅜" through 18" (including insulation thickness).

MS-995 Markers comply with ASME A13.1, except styles J, K, L & N which do not comply with the ASME A13.1 standard regarding marker size and letter height.

Pipe Diameter (Including Insulation)	Marker Style	Marker Width	Character Height	Marker Type
⅜" - ½"	TM	3"	¼"	coil-on
½" - 1"	A	8"	½"	coil-on
1⅛" - 2¼"	B	8"	¾"	coil-on
2½" - 4¾"	D	12"	1¼"	coil-on
5" - 7⅞"	E	12"	1¼"	coil-on
8" - 10"	J*	12"	1¼"	coil-on
11" - 12"	K*	12"	1¼"	coil-on
13" - 15"	L*	12"	1¼"	coil-on
16" - 18"	N*	12"	1¼"	coil-on
Over 8"	M	32"	3½"	carrier

* DOES NOT COMPLY WITH ASME STANDARDS

For piping 8" and larger, the 4" x 32" (style M) marker is permanently laminated to a chemical and weather resistant carrier. Markers are strapped onto the pipe using coated or uncoated stainless steel straps (PG.8-9). Complies with ASME A13.1.



ORDER MS-995 Maxilar™ Markers

- Determine the four-digit part number for each legend.
- Use the marker style table at the bottom right corner of page 4 to determine size of marker desired.
- EXAMPLE: The marker "ACID" for a 2" diameter pipe would be part number 1202B
- Contact us for custom markers

Legend	Color	Part #
#2 FUEL OIL	YEL	1039
#6 FUEL OIL	YEL	1040
150# STEAM	GRN	1200
50# STEAM	GRN	1201
ACID	ORG	1202
ALUM	YEL	1006
AMINE	YEL	1054
AMMONIA	ORG	1203
ASBESTOS FREE INSULATION	BLU	1157
BIOCIDE	YEL	1008
BLACK DYE	YEL	1009
BLACK LIQUOR	YEL	9903
BLEACHED STOCK	YEL	9904
BLUE DYE	YEL	1010
BOILER BLOWDOWN	GRN	1204
BOILER DRAIN	GRN	1205
BOILER FEEDWATER	GRN	1206
BREATHING AIR	BLU	1102
BROKE	YEL	9905
BROWN STOCK	YEL	9906
BUTADIENE	YEL	1014
BUTANE	YEL	1013
BUTENE	YEL	1055
CALCIUM CARBONATE	YEL	9942
CATALYST	YEL	1015
CAUSTIC	ORG	1207
CAUSTIC SODA	ORG	1208
CHILLED WATER RETURN	GRN	1016
CHILLED WATER SUPPLY	GRN	1017
CHLORINE	ORG	1209
CHLORINE DIOXIDE	YEL	9909
CIP RETURN	ORG	1210
CIP SUPPLY	ORG	1211
CITY WATER	GRN	1140
CLARIFIED WHITE LIQUOR	YEL	1018
CLEAN CONDENSATE	YEL	1019
CLOUDY WHITE WATER	YEL	1020
COATED BROKE	YEL	1021
COATING SLURRY	YEL	1056
COLD WATER	GRN	1141
COMPRESSED AIR	BLU	1022
COMPRESSED AIR	YEL	1057
CONDENSATE	GRN	1212
CONDENSER WATER RETURN	GRN	1023
CONDENSER WATER SUPPLY	GRN	1024
CONTAMINATED CONDENSATE	YEL	1028
COOLING WATER	GRN	1025
COOLING WATER RETURN	GRN	1106
COOLING WATER SUPPLY	GRN	1107
CRUDE OIL	YEL	1026
DEFOAMER	YEL	9911
DEMINERALIZED WATER	GRN	1027
DILUTION WATER	YEL	9948
DRAIN	ORG	1213
DRINKING WATER	GRN	1030
EFFLUENT	YEL	1031
ETHYLENE	YEL	1032
ETHYLENE GLYCOL	YEL	1109
FEED STOCK	YEL	1033

Legend	Color	Part #
FILTERED WATER	GRN	9914
FILTRATE	YEL	9913
FIRE PROTECTION WATER	RED	1034
FLARE	YEL	1035
FLOOR DRAIN	YEL	1036
FLUSH WATER	YEL	1061
FOUL CONDENSATE	YEL	9949
FRESH WATER	GRN	1037
FUEL GAS	YEL	1038
FUEL OIL	YEL	9950
GAS	YEL	1144
GLYCOL	ORG	1214
GLYCOL RETURN	ORG	1215
GLYCOL SUPPLY	ORG	1216
GREEN LIQUOR	YEL	9915
GROUNDWOOD	GRN	1041
HARDWOOD STOCK	YEL	9916
HEATING WATER RETURN	GRN	1217
HEATING WATER SUPPLY	GRN	1218
HEAVY BLACK LIQUOR	YEL	9951
HEXANE	YEL	1043
HI PRESS CONDENSATE	GRN	1219
HI PRESS GAS	YEL	1113
HI PRESS SHOWER WATER	YEL	1045
HI PRESS STEAM	GRN	1220
HOT GAS	YEL	1115
HOT WATER	GRN	1221
HOT WATER RETURN	GRN	1222
HOT WATER SUPPLY	GRN	1223
HYDRAULIC OIL	YEL	9917
HYDROCHLORIC ACID	ORG	1224
HYDROGEN	ORG	1225
HYDROGEN PEROXIDE	YEL	1048
HYDROGEN SULFIDE	YEL	1049
IGNITER GAS	YEL	1050
INSTRUMENT AIR	BLU	9918
INSTRUMENT NITROGEN	ORG	1226
ISO-BUTANE	YEL	1051
ISO-BUTYLENE	YEL	1052
KEROSENE	YEL	1062
LO PRESS CONDENSATE	GRN	1227
LO PRESS STEAM	GRN	1228
LUBE OIL	YEL	9920
LUBE OIL RETURN	YEL	1147
LUBE OIL SUPPLY	YEL	1148
MAKE UP WATER	GRN	1053
MED PRESS CONDENSATE	YEL	9946
MEDIUM PRESS STEAM	GRN	1229
METHANOL	ORG	1230
MILL AIR	BLU	9921
MILL WATER	GRN	9922
MTBE	YEL	1063
NATURAL GAS	YEL	9923
NITROGEN	ORG	1231
NON CONDENSABLE GAS	YEL	9953
NON POTABLE WATER	GRN	1232
NORMAL BUTANE	YEL	1067
OFF GAS	YEL	1068
OVERFLOW	ORG	1233

Legend	Color	Part #
OXYGEN	BLU	1234
PLANT AIR	BLU	9924
PLANT WATER	GRN	9925
POTABLE WATER	GRN	9968
PROCESS WATER	GRN	1069
PROCESS WATER RETURN	GRN	1149
PROCESS WATER SUPPLY	GRN	1150
PROPANE	YEL	9971
PULP	YEL	9962
QUENCH WATER	YEL	1129
RAFFINATE	YEL	1070
RAW WATER	GRN	9963
RED DYE	YEL	9972
REJECTS	YEL	9927
RELIEF	ORG	1235
RETENTION AID	YEL	9974
ROOF DRAIN	GRN	9975
SALTCAKE	YEL	9976
SANITARY DRAIN	GRN	1131
SANITARY SEWER	GRN	1130
SEAL WATER	GRN	9928
SHOWER WATER	YEL	9977
SIZE	YEL	9978
SOAP	YEL	9979
SODA ASH	YEL	9980
SODIUM CHLORATE	ORG	1236
SODIUM HYDROXIDE	ORG	1237
SOFT WATER	GRN	1151
SOFTWOOD STOCK	YEL	9929
STARCH	ORG	1238
STEAM	GRN	9938
STEAM CONDENSATE	GRN	1239
STOCK	GRN	9930
STORM DRAIN	GRN	1153
STORM SEWER	GRN	1154
STORM WATER	GRN	1071
STRONG BLACK LIQUOR	YEL	9959
SULFUR DIOXIDE	ORG	1240
SULFURIC ACID	ORG	1241
TALL OIL	YEL	9995
TITANIUM DIOXIDE	YEL	9996
TOWER WATER RETURN	GRN	9997
TOWER WATER SUPPLY	GRN	9998
TREATED WATER	GRN	9999
TURPENTINE	YEL	1001
UNBLEACHED STOCK	YEL	9960
UTILITY WATER	GRN	1242
VACUUM	ORG	1243
VENT	ORG	1244
WASTE OIL	YEL	1073
WASTE WATER	YEL	1002
WATER	GRN	1159
WATER	ORG	1245
WEAK BLACK LIQUOR	YEL	9937
WEAK WASH	YEL	9961
WELL WATER	GRN	1155
WHITE LIQUOR	YEL	9939
WHITE WATER	YEL	9940
YELLOW DYE	YEL	1003

MS-995 Maxilar™ Rigid Curved Carrier Markers

MS-995 rigid curved carrier is a strap-on type pipe marker consisting of a mechanically applied MS-995 pipe label and two slotted nylon feet. The MS-995 strap-on pipe markers may be used in all applications of piping from ¾" and greater in outside diameter including insulation. A coated stainless steel banding is recommended.

These carriers are of a universal design, with full length slots on the reverse side to allow for a wide variety of attachment points. The foot assembly may be strapped to the pipe prior to attaching the carrier or the carrier assembly may be strapped as a unit to the pipe, allowing for maximum installation flexibility.

The marker can include pipe-specific information for identification of process lines, and pipe contents used in utilities. Flow direction can be indicated by an included arrow overlay label of the same material, applied to the carrier when the marker is installed. The MS-1000™ clear top laminate on the carrier label functions as an ultra-violet filter, providing maximum protection against fading due to prolonged exposure to direct sunlight. This also provides excellent resistance to hydrocarbons, acids, bases and most solvents. The curved shape reduces the direct constant UV exposure to sunlight and helps readability. These carrier assemblies have been designed and tested to withstand up to 150 mph wind velocity for one hour, when installed as recommended. Complies with ANSI 13.1.



Pipe Diameter	Part #	Marker Size	Carrier Size
¾" - 1 7/8"	995MBJ	1 ½" x 9"	2.2" x 10"
2" - 7 7/8"	995MBF	2 ¼" x 16"	3 ½" x 17"
8" or greater	995MB	4" x 32"	5" x 33"

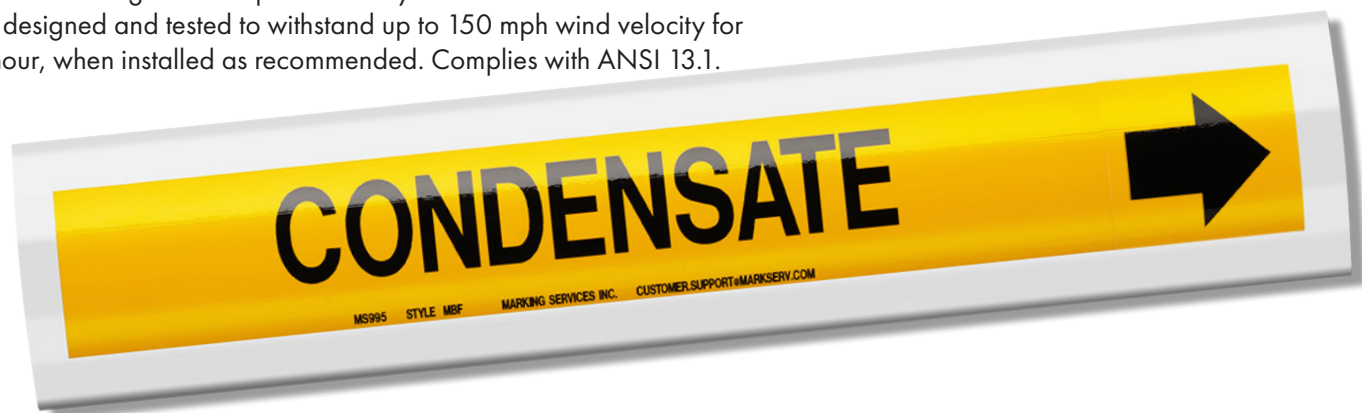

Part #	Pipe Diameter	Size
15703	Up to 2 ½"	16"
15700	3" - 4 ¾"	24"
15701	5" - 8"	33"
157014	9" - 12"	46"
157016	13" - 18"	65"

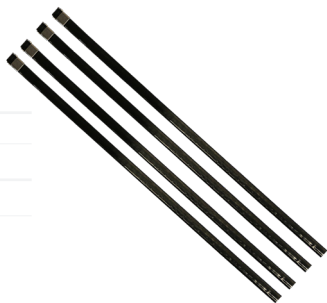

Pre-cut Coated Stainless Steel Straps

Easy to install, cut-to-length stainless steel straps for use with carrier style markers. Durable ¼" wide stainless steel straps come with attached locking clip. Use with locking tool #15716.

Part# 15727



Coated Coil of Strapping

100' coil of ¼" steel. Used for attaching carrier pipe markers. Used with locking clip #15728 and locking tool #15716.

MS-995 High-Temperature Stainless Steel Marker

MS-995 stainless steel pipe markers are for use on piping that has a surface temperature range up to 350°F.

- Markers consist of MS-995 label mechanically applied to a flat stainless steel carrier
- Includes stand-off brackets with heat-reducing spacers to hold the printed pipe marker away from the heat of the pipe's surface
- Available in standard sizes: 2¾" x 18½" or 4¾" x 36"

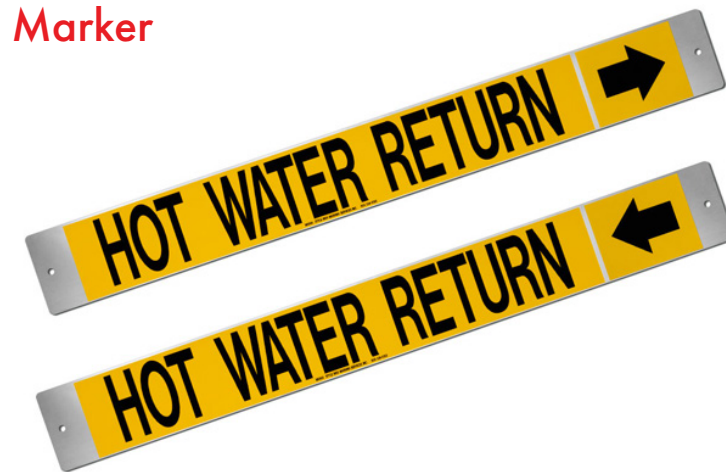

Part# 15725



Coil of Strapping

100' coil of ¼" steel. Used for attaching carrier pipe markers. Used with locking clip #15728 and locking tool #15716.

Part #15607



Stainless Steel Mounting Brackets

Used to mount signs or pipe markers onto piping or tanks. Bolt and hardware included. Use stainless steel straps to affix.

Part# 15728

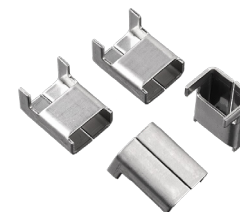

Locking Clips for Strap

Stainless steel clips designed to be used with coiled strapping. Clips packaged 100 per bag.

Part# 15716



Locking Tool for Coil Strap

This tool is used to attach a coil strap, cut to size, from 100' coil. The tool easily tightens the strap forming a permanent lock.

MS-900 Medical Gas Markers

MS-900 Medical Gas Markers are an economical and easy way to mark tubing or piping less than 1" in diameter. Manufactured per NFPA-99C; CGA C9-2002.

- Color, legend and flow direction arrows combined on one pressure-sensitive marker
- Markers are 3" x 3" and wrap completely around the pipe for easy installation. 4" x 4" & 6" x 6" also available
- Supplied in individual pieces, or rolls of 100 per roll – order the exact quantity of labels you need.



MS-900 Markers for Tubing & Small-Bore Piping

MS-900 self-adhesive tubing and small bore markers are an economical and easy way to mark tubing or piping less than 1" in diameter. Our tubing and small bore markers are suitable for line marking identification and system color coding.

- Color, legend and flow direction arrows combined on one pressure-sensitive marker
- Markers are 3" x 3" and wrap completely around the pipe for easy installation. 4" x 4" & 6" x 6" also available.
- Supplied in individual pieces, or rolls of 100 per roll – order the exact quantity of labels you need
- ASME A13.1-1996 Colors available



Legend	Background Color	Letter Color	Part #
CARBON DIOXIDE	GRY	WHT	68501
CARBON DIOXIDE 50 PSI	GRY	WHT	68502
HELIUM	BRN	WHT	68503
LAB AIR	YEL&WHT CHECKERED	BLK	68518
LAB VAC	BLK&WHT CHECKERED	BLK	68519
MEDICAL AIR	YEL	BLK	68504
MEDICAL AIR 50 PSI	YEL	BLK	68512
MEDICAL EVAC	PURP	WHT	68510
MEDICAL VACUUM	WHT	BLK	68506
NITROGEN	BLK	WHT	68507
NITROGEN 160 PSI	BLK	WHT	68514
NITROUS OXIDE	BLU	WHT	68508
NITROUS OXIDE 50 PSI	BLU	WHT	68516
OXYGEN	GRN	WHT	68509
OXYGEN 50 PSI	GRN	WHT	68517
WAGD	PUR	WHT	68511

Legend	Background Color	Part #
ACETYLENE	YEL	66501
ACID	YEL	66502
AIR	BLU	66503
CAUSTIC	YEL	66504
CHEMICAL FEED	YEL	66505
CHLORINE	YEL	66506
CHLORINE LIQUID	YEL	66507
CHLORINE SOLUTION	YEL	66508
CLEAN DRY AIR	BLU	66529
COMPRESSED AIR	YEL	66509
DEIONIZED WATER	GRN	66510
DEMINERALIZED WATER	GRN	66511
DOMESTIC COLD WATER	GRN	66512
DOMESTIC HOT WATER	GRN	66538
EVACUATION VACUUM	YEL	66514
GAS	YEL	66528
HELIUM	YEL	66527
HYDRAULIC OIL	YEL	66515
HYDROGEN	YEL	66516
INSTRUMENT AIR	BLU	66517
LAB AIR	YEL	66519
LAB GAS	YEL	66520
LAB VACUUM	YEL	66521
LUBE OIL	YEL	66522
NATURAL GAS	YEL	66524
PLANT AIR	BLU	66518
SAMPLE	YEL	66525
VACUUM	YEL	66526
VENT	YEL	66530

MS-900 Duct Markers with Attached Scored Arrow

Used to identify the air flow and equipment in a ductwork system.

- Highly-visible color-coded labels make it easy to differentiate between different systems
- Scored arrow markers designate direction of flow
- Markers can be customized to designate the specific system or equipment of origin
- Self-Adhesive

Legend	Background Color	Style A	Style B	Style C	Style D
EXHAUST AIR	YEL	63005	63105	63205	63305
INTAKE AIR	BLU	63020	63120	63220	63320
OUTSIDE AIR	BLU	63009	63109	63209	63309
RELIEF AIR	BLU	63011	63111	63211	63311
RETURN AIR	BLU	63012	63112	63212	63312
SUPPLY AIR	BLU	63016	63116	63216	63316



MS-900 Plenum Duct Markers

Plenum rated duct markers are metalized self-adhesive labels tested to meet the requirements of E-84-03 "Standard Test Method" for surface burning characteristics of building materials.

- Standard plenum rated duct markers are available with black text on metallic grey background
- Designed for use in plenums to help prevent the spread of smoke and gases in the event of a fire
- Custom colors available

Legend	Background Color	2¼" x 13" Part #	4" x 24" Part #
EXHAUST AIR	METALLIC GREY	92601	93601
INTAKE AIR	METALLIC GREY	92602	93602
OUTSIDE AIR	METALLIC GREY	92603	93603
RELIEF AIR	METALLIC GREY	92604	93604
RETURN AIR	METALLIC GREY	92605	93605
SUPPLY AIR	METALLIC GREY	92606	93606
ARROW	METALLIC GREY	92607	93607



MS-900 Economy Pipe Markers

- Each economy self-adhesive marker is supplied in rolls of 50 identical markers and flow directional arrows
- Markers are 2" x 9" and the directional arrows are 2" x 4½". Letter/arrow height is 1¼"
- Scores between markers and arrows ensure handling and application
- Use separately or with color banding tape for complete low-cost marking system



Note: Longer legends are abbreviated to fit available space.
This product does not comply with ASME A13.1 Standard regarding marker size and letter height.

Legend	Color	Part #
ACID	YEL	65101
AIR	BLU	65102
BOILER FEEDWATER	YEL	65140
CHILLED WATER	GRN	65106
CHILLED WATER RETURN	GRN	65129
CHILLED WATER SUPPLY	GRN	65130
CITY WATER	GRN	65107
COLD WATER	GRN	65108
COMPRESSED AIR	YEL	65109
CONDENSATE	YEL	65110
CONDENSATE RETURN	YEL	65141
CONDENSER WATER	GRN	65111
CONDENSER WATER RETURN	GRN	65142
CONDENSER WATER SUPPLY	GRN	65143
DEIONIZED WATER	GRN	65144
DOMESTIC COLD WATER	GRN	65131
DOMESTIC HOT WATER	YEL	65132
DRAIN	GRN	65112
EXHAUST AIR	YEL	65160
FIRE PROTECTION WATER	RED	65113
FUEL OIL	YEL	65145
GAS	YEL	65114
GLYCOL	YEL	65146
HEATING	YEL	65115
HEATING RETURN	YEL	65133
HEATING SUPPLY	YEL	65134
HEATING WATER RETURN	YEL	65156
HEATING WATER SUPPLY	YEL	65157
HI PRESS CONDENSATE	YEL	65147
HI PRESS STEAM	YEL	65148
HOT WATER	YEL	65135
HOT WATER RETURN	YEL	65136
HOT WATER SUPPLY	YEL	65137
INTAKE AIR	BLU	65161
LO PRESS CONDENSATE	YEL	65149
LO PRESS STEAM	YEL	65150
NATURAL GAS	YEL	65116
NITROGEN	GRN	65151
NON POTABLE WATER	YEL	65138
OIL	YEL	65117
OUTSIDE AIR	BLU	65162
OXYGEN	YEL	65118
POTABLE WATER	GRN	65119
RECIRCULATING HOT WATER	YEL	65159
RELIEF AIR	BLU	65163
RETURN	YEL	65120
RETURN	GRN	65121
RETURN AIR	BLU	65164
ROOF DRAIN	GRN	65152
SANITARY DRAIN	GRN	65158
SANITARY SEWER	GRN	65153
SPRINKLER WATER	RED	65122
STEAM	YEL	65123
SUPPLY	YEL	65124
SUPPLY	GRN	65125
SUPPLY AIR	BLU	65165
VACUUM	YEL	65126
VENT	YEL	65127
WASTEWATER	YEL	65154
WATER	GRN	65128

MS-900 Roll Markers

Convenient "one-size-fits-all" MS-900 Roll Markers wrap around all diameters of pipe.

- Easy-to-use adhesive markers wrap around any size pipe. Simply peel the liner from the label and adhere the marker around the pipe
- Rolls are 6½" wide and can be cut to the length needed to fit around the pipe
- Letters are 1¼" in height. Legends and flow arrows are printed every six inches
- Roll size 6½" x 30'
- Legend is repeated 60 times per roll



Note: Longer legends are abbreviated to fit available space.
This product does not comply with ASME A13.1 Standard regarding marker size and letter height.

Legend	Color	Part #
ACID	YEL	64001
AIR	BLU	64002
ASBESTOS FREE INSULATION	BLU	64003
BOILER FEEDWATER	YEL	64004
CAUSTIC	YEL	64005
CHILLED WATER	GRN	64006
CHILLED WATER RETURN	GRN	64007
CHILLED WATER SUPPLY	GRN	64008
CITY WATER	GRN	64009
COLD WATER	GRN	64010
COMPRESSED AIR	BLU	64011
COMPRESSED AIR	YEL	64012
CONDENSATE	YEL	64013
CONDENSATE RETURN	YEL	64014
CONDENSER WATER	GRN	64015
CONDENSER WATER RETURN	GRN	64016
CONDENSER WATER SUPPLY	GRN	64017
COOLING WATER RETURN	GRN	64018
COOLING WATER SUPPLY	GRN	64019
DOMESTIC COLD WATER	GRN	64020
DOMESTIC HOT WATER	YEL	64021
DRAIN	YEL	64022
FIRE PROTECTION WATER	RED	64023
FUEL OIL	YEL	64024
GAS	YEL	64025
GLYCOL RETURN	YEL	64026
GLYCOL SUPPLY	YEL	64027
HEATING RETURN	YEL	64028
HEATING SUPPLY	YEL	64029
HEATING WATER RETURN	YEL	64030
HEATING WATER SUPPLY	YEL	64031
HI PRESS CONDENSATE	YEL	64032
HI PRESS STEAM	YEL	64033
HOT WATER	YEL	64034
HOT WATER RETURN	YEL	64035
HOT WATER SUPPLY	YEL	64036
LO PRESS CONDENSATE	YEL	64037
LO PRESS STEAM	YEL	64038
MEDIUM PRESS STEAM	YEL	64039
NATURAL GAS	YEL	64040
NITROGEN	GRN	64041
NON POTABLE WATER	YEL	64042
OIL	YEL	64043
OXYGEN	YEL	64044
POTABLE WATER	GRN	64045
RETURN	YEL	64046
RETURN	GRN	64047
ROOF DRAIN	GRN	64048
SANITARY DRAIN	GRN	64049
SANITARY SEWER	GRN	64050
SPRINKLER WATER	RED	64051
STEAM	YEL	64052
SUPPLY	YEL	64053
SUPPLY	GRN	64054
VACUUM	YEL	64055
VENT	YEL	64056
WASTEWATER	YEL	64057
WATER	GRN	64058

MS-900 Mini Markers

These Self-Adhesive Mini Pipe Markers (style "T") are great for labeling ¼" to ¾" process lines, tool connections or utility piping. Our mini pipe markers are suitable for line marking identification and system color coding.

Mini Pipe Markers are made from durable material with pressure-sensitive adhesive, making them easy to install. Simply clean and dry the pipe, remove the marker from the coated paper backing and place in the desired location.

- Identify the piping carrying chemicals and gases used in the production of semi-conductors and components
- Easy-to-install, adhesive backed, permanent markers
- Custom legends, chemical abbreviations and point of connection labels are available
- Style T markers are ½" x 2½" and sold 10 labels per sheet

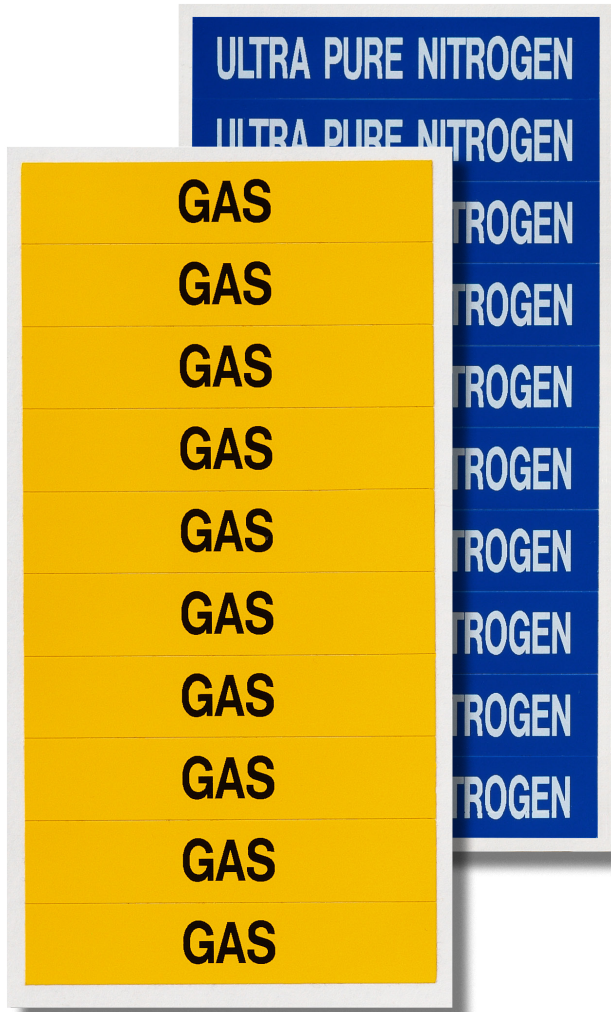

Legend	Color	Part #	Legend	Color	Part #
ACETLYENE GAS	YEL	95000	HOUSE VACUUM	YEL	95037
ACID	YEL	95001	INDUSTRIAL COLD WATER	GRN	95039
ACID WASTE DRAIN	YEL	95002	INDUSTRIAL HOT WATER	YEL	95040
AMMONIA	YEL	95003	INSTRUMENT AIR	BLU	95041
AMMONIA HYDROXIDE	YEL	95004	INSTRUMENT NITROGEN	BLU	95042
ARGON	BLU	95073	ISOPROPYL ALCOHOL	YEL	95043
ARROW	YEL	95005	LUBE OIL	YEL	95044
ARROW	GRN	95006	METHANOL	YEL	95045
ARROW	BLU	95007	NATURAL GAS	YEL	95046
ARROW	RED	95008	NITROGEN	BLU	95074
BORON TRICHLORIDE	YEL	95009	NITRIC ACID	YEL	95047
BREATHING AIR	BLU	95010	NITROGEN TRIFLOURIDE	YEL	95048
CAUSTIC	YEL	95011	NITROUS OXIDE	YEL	95049
CHEMICAL FEED	YEL	95012	OIL FREE AIR	BLU	95050
CHILLED WATER RETURN	GRN	95013	OXYGEN	YEL	95051
CHILLED WATER SUPPLY	GRN	95014	OUTSIDE AIR	BLU	95052
CHLORINE	YEL	95015	OZONE	YEL	95053
CHLORINE SOLUTION	YEL	95016	PHOSPHORIC ACID	YEL	95054
CITY WATER	GRN	95017	PLANT AIR	BLU	95055
CLEAN DRY AIR	BLU	95018	PROCESS COOLING WAT RET	GRN	95056
COMPRESSED AIR	BLU	95019	PROCESS COOLING WAT SUP	GRN	95057
CORROSIVE VENT	YEL	95020	PROCESSED EXHAUST	YEL	95058
DEIONIZED WATER	GRN	95021	PROCESSED VACUUM	YEL	95059
DEIONIZED WATER RETURN	GRN	95022	RO RETURN	GRN	95060
DEIONIZED WATER SUPPLY	GRN	95023	RO SUPPLY	GRN	95061
DEMINERALIZED WATER	GRN	95024	SILANE	YEL	95063
DOMESTIC COLD WATER	GRN	95025	SOLVENT RECLAIM	YEL	95075
DOMESTIC HOT WATER	YEL	95026	SOLVENT VENT	YEL	95064
ETHYLENE GLYCOL	YEL	95027	SULFUR HEXAFLOURIDE	YEL	95065
EVACUATION VACUUM	YEL	95028	SULFURIC ACID	YEL	95066
FREON	YEL	95029	ULTRA PURE NITROGEN	BLU	95072
GAS	YEL	95030	ULTRA PURE WATER DI RET	YEL	95076
HELIUM	YEL	95031	ULTRA PURE WATER DI SUP	YEL	95077
HIGH PURITY NITROGEN	YEL	95032	ULTRA PURE WATER RET	GRN	95067
HYDRAULIC OIL	YEL	95038	ULTRA PURE WATER SUP	GRN	95068
HYDROFLUORIC ACID	YEL	95033	UTILITY NITROGEN	BLU	95069
HYDROGEN	YEL	95034	UTILITY WATER	GRN	95070
HYDROGEN BROMIDE	YEL	95035	VACUUM	BLU	95071
HYDROGEN CHLORIDE	YEL	95036	WATER	GRN	95078

Note: Legends are abbreviated to fit available space

Reusable Plastic Stencils and
Pre-cut Oilboard Stencils

- Available in several different sizes with larger stencils available upon request
- Letter heights to comply with ASME A13.1 available
- Reusable stencils are cut from 0.010" plastic and can be reused for multiple projects



12 oz. Spray Stencil Ink

- Permanent, quick-drying, weather resistant ink
- Provides high-contrast marking on pipes and insulation

Part #	Color
61101	Black
61101WHT	White
61101BLU	Blue
61101RED	Red
61101YEL	Yellow
61101GRN	Green
61101ORG	Orange

Locator Tacks

Ceiling markers are an ideal for marking the location of dampers, booster coils and controllers above acoustical ceiling tiles. Simply push equipment locator tacks into ceiling tile or insulation near closest access point.

- ⅝" ceiling tacks
- Come in packs of 25
- Serrated ceiling markers with and without removable retention disk fastener are available

Part #	Color
35501	Orange
35502	Red
35503	White
35504	Yellow
35505	Black
35506	Green
35507	Blue



MS-900 Color Banding Tape

When engineering specifications or customer preference require pipe color coding, use MS-900 Color Banding Tape.

- For color coding in high sunlight areas request UV-protective over-laminate to triple useful life
- Complies with MIL-SPEC 101B
- Standard sizes: 1" and 2" wide by 50 yds long
- Also available in 3", 4" and 6" wide rolls
- Self-Adhesive

Color	1" x 50yd Part #	2" x 50yd Part #
YEL	96101	96201
GRN	96102	96202
RED	96103	96203
BLU	96104	96204
BRN	96015	96205
WHT	96106	96206
BLK	96107	96207
GRY	96108	96208
ORG	96109	96209
PUR	96110	96210



MS-900 Flow Directional Arrow Tape

Designed to indicate direction of flow when used with MS-900 pipe markers.

- Standard roll sizes are 1", 2" & 4" wide by 30 yds long. Custom sizes are also available
- Complies with ASME A13.1 requirement to show flow direction
- Custom colors available
- Self-Adhesive

Use this chart to determine how many rolls of tape are required.

Pipe Diameter	Tape Length	# Bands/Roll
2"	8" Band	135
4"	14" Band	77
6"	21" Band	51
8"	27" Band	40
10"	35" Band	30
12"	41" Band	26

Size	Yellow w/ Black	Green w/ White	Red w/ White	Blue w/ White	Green w/ Black	Orange w/ Black	White w/ Black
1" x 30 yds	95101	95102	95103	95104	95105	95106	95107
2" x 30 yds	95201	95202	95203	95204	95205	95206	95207
4" x 30 yds	95401	95402	95403	95404	95405	95406	95407



Underground Warning Tape

Color-coded tape guards against costly and dangerous "dig-ins".

- Designed to be buried above metallic underground piping or cables to warn excavators of utility lines
- Non-adhesive 4 mil. polyethylene tape, surface printed available in: 3" x 1000 ft. or 6" x 1000 ft. rolls
- Custom legends available

Legend	Text/Back-ground Color	3" Part #	6" Part #
CAUTION BURIED ELECTRICAL LINE BELOW	BLK/RED	52201	52208
CAUTION BURIED FUEL LINE BELOW	BLK/YEL	52202	52209
CAUTION BURIED NATURAL GAS LINE BELOW	BLK/YEL	52203	52210
CAUTION BURIED PIPE LINE BELOW	BLK/YEL	52204	52211
CAUTION BURIED SEWER LINE BELOW	BLK/GRN	52205	52212
CAUTION BURIED STEAM LINE BELOW	BLK/YEL	52207	52213
CAUTION BURIED WATER LINE BELOW	BLK/BLU	52206	52214
CAUTION CAUTION CAUTION	BLK/YEL	52216	NA



Detectable Underground Warning Tape

MSI offers various options for underground warning tape. Locate buried non-metallic pipes before you dig with MSI detectable underground warning tape.

- Printed 4.5 mil foil detectable warning tape lets you use any standard metal detector to quickly locate underground services
- Available in: 3" x 1000 ft. roll and 6" x 1000 ft. roll
- Recommended burial depths: 3" tape – Less than 24" deep; 6" – More than 24" deep
- Custom legends available

Legend	Text/Back-ground Color	3" Part #	6" Part #
CAUTION BURIED ELECTRIC LINE BELOW	BLK/RED	52215	52220
CAUTION BURIED GAS LINE BELOW	BLK/YEL	52216	52221
CAUTION BURIED OXYGEN LINE BELOW	BLK/GRN	52226	52227
CAUTION BURIED PIPE LINE BELOW	BLK/YEL	52217	52222
CAUTION BURIED SEWER LINE BELOW	BLK/GRN	52218	52223
CAUTION BURIED WATER LINE BELOW	BLK/BLU	52219	52224



Tags

At MSI, we offer a wide variety of tags for many types of identification needs. Our high-quality tags are built to withstand harsh conditions and can be seamlessly integrated with our mobile technology.

1

Asset Identification Tags

Asset ID tags offer our most customizable and durable tags yet. They come in a flexible and a rigid material and are made without engraving, allowing you to put custom colors and images on them, including QR codes to be compatible with mobile technology.

2

Valve & Equipment

Material options for valve & equipment tags are anodized aluminum, engraved plastic, brass, and stainless steel. All of these material options allow for customizations including QR codes. See page 32 for mounting options.

3

Accident Prevention

Accident prevention tags from MSI draw attention to potentially dangerous situations that can put the safety of your employees and operation at risk. Convey pertinent information with APT tags that are designed to withstand harsh environments.

Our tags provide value far beyond the tag itself. With multiple different sizes, materials, and customizations these tags can provide information beyond simple identification. Integrate them with AIM Technology to receive the most value including 24/7 access to a mobile document library, immediate access to asset information, and customizable service and maintenance forms.

MS-215 MAX-TEK™



MS-215 Max-Tek™ Tags

MS-215 tags are constructed of printed legends sealed between two layers of chemically-resistant plastic. This sealed construction offers excellent resistance to chemicals, abrasion and the fading effects of the sun.

- High-performance tags protect the graphics from environmental conditions
- Rigid and Flexible available
- Complete printing flexibility – each unique tag can include multiple lines of text, equipment number, operation and maintenance instructions, safety precautions, or other critical asset information
- Service temperature range: -40° F to 200° F
- Available with adhesive or grommets
- Multiple sizes available
- Double sided tags available
- Photoluminescent material available
- Reflective material available

For Use With AIM Mobile Technology

MSI offers AIM Mobile Technology delivering on-demand 24/7 access to critical asset information. AIM is the integration of asset identification with Mobile technology. MSI QR coded tags provide a direct link to reliable asset information, accessible when installed on valves and equipment at your construction project.



Engraved Plastic Valve Tags

Engraved plastic valve tags for color coding valves, equipment and instrumentation.

- Excellent visibility – Engraved information clearly shows against contrasting background so the tags are easy to read
- Standard tags are engraved on 1/16" plastic stock with mounting holes or adhesive backing [1/8" thick, 3 ply also available]
- Stock colors available: Black, Green, Red, and Blue with White letters; Yellow, Orange and White with Black letters
- Standard sizes: 1 1/2", 2", 3" and 4" round or square shapes
- For indoor as well as outdoor applications
- Custom colors available



Engraved Plastic Equipment Tags

Bright and durable, these engraved plastic equipment tags and signs are designed for labeling pumps, fans, air handling units and other equipment.

- Engraving provides high contrast between letter color and background color for easy visibility
- Excellent for in-house maintenance programs – use to verify machinery numbers shown on work orders which reduces costly errors and accidental shutdowns
- Also ideal for providing building graphics and door signs
- For indoor as well as outdoor applications
- Standard tags are engraved on 1/16" plastic stock with mounting holes or adhesive backing [1/8" thick, 3 ply also available]
- Stock colors available: Black, Green, Red, and Blue with White letters; Yellow, Orange and White with Black letters
- Custom colors available



Brass Valve Tags

Brass valve tags are an effective choice for labeling valves and systems.

- 20 gauge brass tags are available from stock in 1 1/2" and 2" round or square, each with one 3/16" mounting hole
- Each tag is 1/4" service indicator on the top line and 1/2" numbers below
- Packaged in sets of 25 consecutive numbers
- Customized tags available



Anodized Aluminum Tags

Easy to read anodized aluminum valve tags provide a highly visible contrast between the engraved legend and the colored background

- Use to tag valves, instruments, small piping, cables or fugitive emission locations
- .032" thick tags are available in 1 1/2" and 2" round or square, each with one 3/16" mounting hole
- Background colors available: Green, Red, Blue, Gold, Black, Orange and Natural
- Customized tags available



Stainless Steel Tags

Designed to withstand high temperatures, and corrosive or caustic substances. Provides maximum resistance to the effects of weathering and chemicals. Stainless steel valve tags and signs are available in a variety of sizes with or without holes. Type 316 stainless steel is ideal for the highly corrosive environments of process and petrochemical facilities. Tags have blackened text making it easy to read. These durable tags have text permanently engraved and are made to withstand significant handling and abrasive environments and remain completely legible. The engraving process leaves the tag with an indelible, tactile finish.

See Page 32 for mounting options & accessories.

Accident Prevention Tags

Stock accident prevention tags draw attention to potentially dangerous or abnormal plant situations.

- Tag equipment for lockout during maintenance, convey characteristics specific to a piece of equipment or detail maintenance instructions and operating procedures
- Highly visible printed legends will remain effective both indoors and outdoors (24 month outdoor use)
- Durable heavy duty plastic construction provides excellent protection against moisture and the effects of harsh chemical environments
- Each accident prevention tag is 5¾" x 3"
- Stainless steel grommets are used to increase tear resistance during use
- APT tags come with 8" nylon ties for easy installation
- Custom sizes available upon request

ORDER ACCIDENT PREVENTION TAGS

- Determine the four-digit part number
- To order self-laminating, add SL before the part number
- To determine which back, add 1 or 2 to the end of the part number
- EXAMPLE: To order a self-laminating ACID tag with side 1, order part #SL40021. A regular ACID tag with side 2 would be part #40022.



Back 1



Back 2



Self-laminating tags



Part #4002



Part #4003



Part #4004



Part #4005



Part #4006



Part #4007



Part #4033



Part #4034



Part #4035



Part #4036



Part #4037



Part #4038



Part #4008



Part #4009



Part #4010



Part #4011



Part #4012



Part #4013



Part #4039



Part #4040



Part #4041



Part #4042

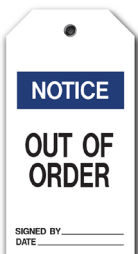

Part #4043



Part #4044



Part #4014



Part #4016



Part #4017



Part #4018



Part #4019



Part #4020



Part #4045



Part #4015



Part #4001



Accident prevention tags are available with custom QR codes.



Part #4021



Part #4022



Part #4023



Part #4024



Part #4025



Part #4026



Part #4027



Part #4028



Part #4029



Part #4030



Part #4031



Part #4032

MS-200 Engraved Tags

MS-200 engraved tags and signs are an economical and easy way to identify valves, instrumentation and equipment. The unique MS-200 material provides a durable marking solution for demanding chemical wash-down environments.

- Gloss finish material with legend sized to fit within tag/sign
- Ideal for equipment subject to frequent wash-downs or chemical cleanings
- Available in standard yellow, orange and white polycarbonate material
- Legend color available in black
- Mounting through holes or adhesive back
- Outdoor durable; 5-year outdoor life
- Service temperature range: -40° F to 180° F
- Material thickness: .100"

**MS-300 Signs & Tags**

MS-300 signs are constructed by subsurface printing on a tough, transparent, thermoplastic material. MS-300 products are suitable for labeling in an FDA compliant environment. They hold up well to radiation and chemical sterilization techniques and are ideal for medical and laboratory environments.

- Chemical and water resistant
- Formable
- Can be made as a metal detectable sign
- Can be used in chemical wash down environments (CIP systems)
- Service temperature range: -40° F to 150° F
- Material thickness: .125" or .060"
- Designed for indoor use



Scan to view our
Technical Data Sheets!

Signs

At MSI, we offer a wide variety of signs for many types of identification needs. Our signs are highly customizable and are built to withstand harsh environments in a variety of industries.

Equipment

Our equipment sign offerings cover a broad range of industries, from ammonia and refrigeration to marine and offshore, to oil, gas and petrochemicals – we conform to the unique regulatory and international requirements of each.

Accident Prevention

Accident prevention and operational & safety signs provide plant personnel with necessary information regarding hazard identification, operating procedures and equipment identification. We offer a number of custom operations and safety signs.

Evacuation & Escape

Photoluminescent Evacuation and Escape Signs clearly identify a safe pathway for evacuation in stairwells, basements, hallways, warehouses, below decks on ships or offshore installations.

Clear and well-placed signage is critical for employee safety and operational efficiency. At MSI we specialize in creating custom signage to provide plant personnel with necessary information regarding hazard identification, operating procedures and equipment identification. Proper signage can help protect against preventable incidents and make your operations run more smoothly.

Stainless Steel Signs

Stainless Steel Equipment signs are typically for use in: Food Processing Plants, Oil and Gas Facilities, Power Generating Stations and Marine and Offshore.

- Type 316 Stainless Steel
- Standard tags have round corners and mounting holes for ease of installation (adhesive available)
- Black Text is laser engraved for visibility and durability
- Available with QR codes
- Standard sizes: 1" x 3" | 2" x 4" | 4" x 6" - Custom sizes available

Stainless Steel Equipment signs are ideal for:

- Nameplates on machinery that continually run at high temperatures
- Valve or instrument identification in highly-corrosive or caustic environments



Custom MS-215 Max-Tek™ Signs

MS-215 Max-Tek™ identification signs can be used in a variety of ways including naming and numbering each tank, vessel or piece of equipment.

- Available in two thicknesses: MS-215 R [125 mil] for rigid requirements and MS-215 F [30 mil] flexible
- For mounting signs on curved surfaces, we recommend the flexible construction
- Excellent outdoor life and chemical resistance
- Available with QR codes
- Multiple color combinations available
- Adhesive or grommets available
- Sizing for your specification

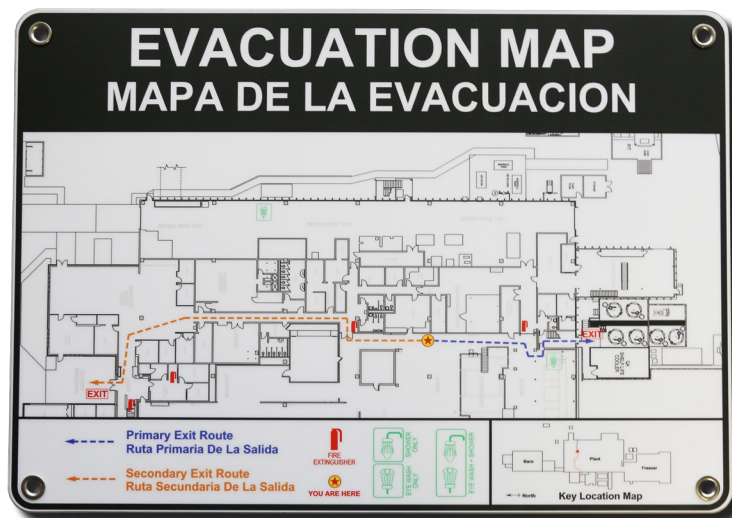

See Page 32 for mounting options & accessories.

Enameled Aluminum Signs

Aluminum equipment signs to identify critical equipment and locations. The enamel background makes an easy to read and aesthetically pleasing equipment sign.

- Use for equipment plates to show model name and characteristics specific to a piece of equipment
- Can be used to show maintenance instructions and operating procedures
- Highly visible contrast between the legend and the background
- Durable indoors and outdoors
- Equipment signs come with standard 3/16" mounting holes (adhesive available)
- .040" thick
- Standard sizes: 1" x 3" | 2" x 4" | 4" x 6" | - Custom sizes available
- Custom colors available



Engraved Plastic Signs

These bright and durable engraved plastic equipment signs and tags for labeling pumps, fans, air handling units and other equipment.

- Engraving provides high contrast between letter color and background color for easy visibility
- Excellent for in-house maintenance programs – use to verify machinery numbers shown on work orders which reduces costly errors and accidental shutdowns
- Also ideal for providing building graphics and door signs
- For indoor as well as outdoor applications
- Standard signs are engraved on 1/16" plastic stock with mounting holes or adhesive backing [1/8" thick, 3 ply is also available]
- Standard sizes: 2" x 4" | 4" x 6" | 6" x 6" | 7" x 10" | 7" x 12" | 7" x 14" | - Custom sizes available
- Stock colors available: Black, Green, Red, and Blue with White letters; Yellow, Orange and White with Black letters
- Custom colors available

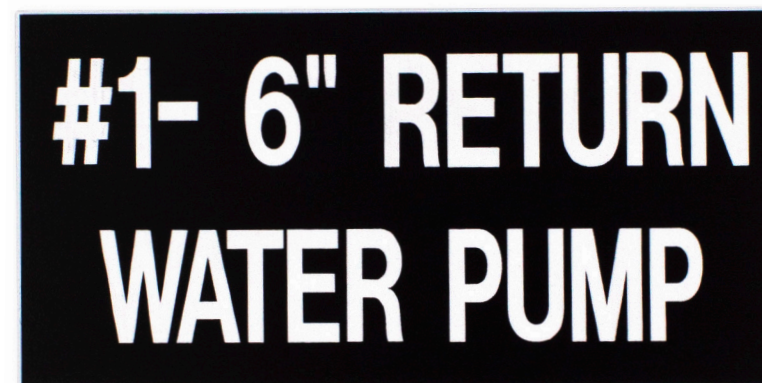

MS-215 Photoluminescent Signs

Photoluminescent Evacuation and Escape Signs from Marking Services clearly identify a safe pathway for evacuation in stairwells, basements, hallways, warehouses, below decks on ships or offshore installations.

- Comply with IMO/SOLAS requirements for identifying essential evacuation and escape routes.
- Available in:
 - MS-260 Photoluminescent outdoor grade flexible or semi-rigid plastic signs
 - MS-960 Photoluminescent self-adhesive labels.
- If verbiage (English/other) or custom signage is needed, please contact an MSI sales representative.



Size: 6" x 18" Part #: IMO 201



Size: 6" x 18" Part #: IMO 204



Size: 6" x 18" Part #: IMO 207



Size: 6" x 18" Part #: IMO 210



Size: 6" x 18" Part #: IMO 213



Size: 6" x 18" Part #: IMO 216



Size: 6" x 18" Part #: IMO 202



Size: 6" x 18" Part #: IMO 205



Size: 6" x 18" Part #: IMO 208



Size: 6" x 18" Part #: IMO 211



Size: 6" x 18" Part #: IMO 214



Size: 6" x 18" Part #: IMO 217



Size: 6" x 18" Part #: IMO 203



Size: 6" x 18" Part #: IMO 206



Size: 6" x 18" Part #: IMO 209



Size: 6" x 18" Part #: IMO 212



Size: 6" x 18" Part #: IMO 215



Size: 6" x 18" Part #: IMO 218



Size: 6" x 18" Part #: IMO 219



Size: 6" x 18" Part #: IMO 222



Size: 4" x 12" Part #: IMO 225



Size: 4" x 12" Part #: IMO 228



Size: 4" x 12" Part #: IMO 231



Size: 4" x 12" Part #: IMO 234



Size: 6" x 18" Part #: IMO 220



Size: 6" x 18" Part #: IMO 223



Size: 4" x 12" Part #: IMO 226



Size: 4" x 12" Part #: IMO 229



Size: 4" x 12" Part #: IMO 232



Size: 4" x 12" Part #: IMO 235



Size: 6" x 18" Part #: IMO 221



Size: 6" x 18" Part #: IMO 224

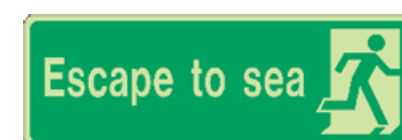

Size: 4" x 12" Part #: IMO 227



Size: 4" x 12" Part #: IMO 230

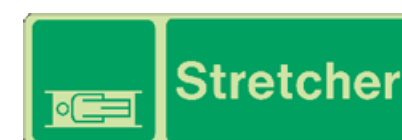

Size: 4" x 12" Part #: IMO 233



Size: 4" x 12" Part #: IMO 236



Clear and well-placed marine and offshore signs are critical for employee safety and operational efficiency. We specialize in creating highly-descriptive marine and offshore signs to provide plant personnel with necessary information regarding hazard identification, operating procedures and equipment identification.

Safety/Operational Signs

Operational and safety signs provide plant personnel with necessary information regarding hazard identification, operating procedures and equipment identification. MSI offers a number of stock operations and safety signs.

- High performance MS-215R Max-Tek™ rigid plastic signs offer the ultimate in outdoor durability (available with grommets or adhesive)
- MS-900 Self Adhesive signs (SAS) for environments not subject to washdown chemicals or UV exposure
- Custom materials and signs available

DANGER ACID EYE PROTECTION AND PROTECTIVE CLOTHING REQUIRED	DANGER AUTHORIZED PERSONNEL ONLY	DANGER CAUSTIC EYE PROTECTION AND PROTECTIVE CLOTHING REQUIRED	DANGER CHEMICAL UNLOADING AREA AUTHORIZED PERSONNEL ONLY	DANGER CHLORINE EYE PROTECTION AND PROTECTIVE CLOTHING REQUIRED	DANGER CONFINED SPACE AUTHORIZED PERSONNEL ONLY	DANGER CONFINED SPACE ENTER BY PERMIT ONLY
Size 215-R SAS 7"x12" 80000 82000 10"x14" 80001 82001 12"x20" 80002 82002	Size 215-R SAS 7"x12" 80003 82003 10"x14" 80004 82004 12"x20" 80005 82005	Size 215-R SAS 7"x12" 80006 82006 10"x14" 80007 82007 12"x20" 80008 82008	Size 215-R SAS 7"x12" 80009 82009 10"x14" 80010 82010 12"x20" 80011 82011	Size 215-R SAS 7"x12" 80012 82012 10"x14" 80013 82013 12"x20" 80014 82014	Size 215-R SAS 7"x12" 80015 82015 10"x14" 80016 82016 12"x20" 80017 82017	Size 215-R SAS 7"x12" 80018 82018 10"x14" 80019 82019 12"x20" 80020 82020
DANGER DO NOT ENTER	DANGER EAR PROTECTION REQUIRED BEYOND THIS POINT	DANGER EYE PROTECTION REQUIRED BEYOND THIS POINT	DANGER EAR AND EYE PROTECTION REQUIRED IN THIS AREA	DANGER FLAMMABLE MATERIAL NO MATCHES OR OPEN FLAMES	DANGER HARD HATS REQUIRED BEYOND THIS POINT	DANGER HARD HAT AREA
Size 215-R SAS 7"x12" 80021 82021 10"x14" 80022 82022 12"x20" 80023 82023	Size 215-R SAS 7"x12" 80024 82024 10"x14" 80025 82025 12"x20" 80026 82026	Size 215-R SAS 7"x12" 80027 82027 10"x14" 80028 82028 12"x20" 80029 82029	Size 215-R SAS 7"x12" 80030 82030 10"x14" 80031 82031 12"x20" 80032 82032	Size 215-R SAS 7"x12" 80033 82033 10"x14" 80034 82034 12"x20" 80035 82035	Size 215-R SAS 7"x12" 80036 82036 10"x14" 80037 82037 12"x20" 80038 82038	Size 215-R SAS 7"x12" 80039 82039 10"x14" 80040 82040 12"x20" 80041 82041
DANGER HAZARDOUS AREA AUTHORIZED PERSONNEL ONLY	DANGER HEARING PROTECTION REQUIRED IN THIS AREA	DANGER HIGH PRESSURE GAS LINE	DANGER HIGH VOLTAGE	DANGER HIGH VOLTAGE KEEP OUT	DANGER KEEP OUT	DANGER NITROGEN STORAGE AREA
Size 215-R SAS 7"x12" 80042 82042 10"x14" 80043 82043 12"x20" 80044 82044	Size 215-R SAS 7"x12" 80045 82045 10"x14" 80046 82046 12"x20" 80047 82047	Size 215-R SAS 7"x12" 80048 82048 10"x14" 80049 82049 12"x20" 80050 82050	Size 215-R SAS 7"x12" 80051 82051 10"x14" 80052 82052 12"x20" 80053 82053	Size 215-R SAS 7"x12" 80054 82054 10"x14" 80055 82055 12"x20" 80056 82056	Size 215-R SAS 7"x12" 80057 82057 10"x14" 80058 82058 12"x20" 80059 82059	Size 215-R SAS 7"x12" 80060 82060 10"x14" 80061 82061 12"x20" 80062 82062
DANGER NO SMOKING	DANGER NO SMOKING BEYOND THIS POINT	DANGER SMOKING IN DESIGNATED AREAS	DANGER PROPANE GAS AUTHORIZED PERSONNEL ONLY	DANGER PERSONAL PROTECTIVE EQUIPMENT MUST BE WORN IN THIS AREA	DANGER SULFURIC ACID EYE PROTECTION AND PROTECTIVE CLOTHING REQUIRED	DANGER THIS EQUIPMENT STARTS AUTOMATICALLY
Size 215-R SAS 7"x12" 80063 82063 10"x14" 80064 82064 12"x20" 80065 82065	Size 215-R SAS 7"x12" 80066 82066 10"x14" 80067 82067 12"x20" 80068 82068	Size 215-R SAS 7"x12" 80069 82069 10"x14" 80070 82070 12"x20" 80071 82071	Size 215-R SAS 7"x12" 80072 82072 10"x14" 80073 82073 12"x20" 80074 82074	Size 215-R SAS 7"x12" 80075 82075 10"x14" 80076 82076 12"x20" 80077 82077	Size 215-R SAS 7"x12" 80078 82078 10"x14" 80079 82079 12"x20" 80080 82080	Size 215-R SAS 7"x12" 80081 82081 10"x14" 80082 82082 12"x20" 80083 82083
DANGER WATCH OUT FOR FORKLIFT TRAFFIC IN THIS AREA	DANGER WEAR FACE SHIELDS AND GLOVES WHEN UNLOADING CHEMICALS	CAUTION AUTHORIZED PERSONNEL ONLY	CAUTION EYE AND EAR PROTECTION MUST BE WORN IN THIS AREA	CAUTION FORKLIFT TRAFFIC KEEP CLEAR	CAUTION HARD HAT AREA	CAUTION SAFETY SHOES MUST BE WORN IN THIS AREA
Size 215-R SAS 7"x12" 80084 82084 10"x14" 80085 82085 12"x20" 80086 82086	Size 215-R SAS 7"x12" 80087 82087 10"x14" 80088 82088 12"x20" 80089 82089	Size 215-R SAS 7"x12" 80090 82090 10"x14" 80091 82091 12"x20" 80092 82092	Size 215-R SAS 7"x12" 80093 82093 10"x14" 80094 82094 12"x20" 80095 82095	Size 215-R SAS 7"x12" 80096 82096 10"x14" 80097 82097 12"x20" 80098 82098	Size 215-R SAS 7"x12" 80099 82099 10"x14" 80100 82100 12"x20" 80101 82101	Size 215-R SAS 7"x12" 80102 82102 10"x14" 80103 82103 12"x20" 80104 82104
NOTICE AUTHORIZED PERSONNEL ONLY	NOTICE HARD HATS MUST BE WORN IN THIS AREA	NOTICE WHEEL CHOCKS REQUIRED FOR LOADING AND UNLOADING	EMERGENCY EYE WASH STATION	EMERGENCY SAFETY SHOWER		
Size 215-R SAS 7"x12" 80105 82105 10"x14" 80106 82106 12"x20" 80107 82107	Size 215-R SAS 7"x12" 80108 82108 10"x14" 80109 82109 12"x20" 80110 82110	Size 215-R SAS 7"x12" 80111 82111 10"x14" 80112 82112 12"x20" 80113 82113	Size 215-R SAS 7"x12" 80114 82114 10"x14" 80115 82115 12"x20" 80116 82116	Size 215-R SAS 7"x12" 80117 82117 10"x14" 80118 82118 12"x20" 80119 82119		

GHS Signs (Globally Harmonized System)

GHS signs are specifically designed to comply with the standards established by the United Nations. Use our sign to identify health, physical and environmental risk hazards; information critical to keep your workplace compliant and safe. Standardized pictograms, signal words and hazard/precautionary statements used on our GHS signs keep workers informed of specific chemical hazards and comply with GHS regulations.

Need additional information such as NFPA diamonds or HMIS? We can create signs with all the required information based on your specifications, while remaining compliant with GHS regulations.

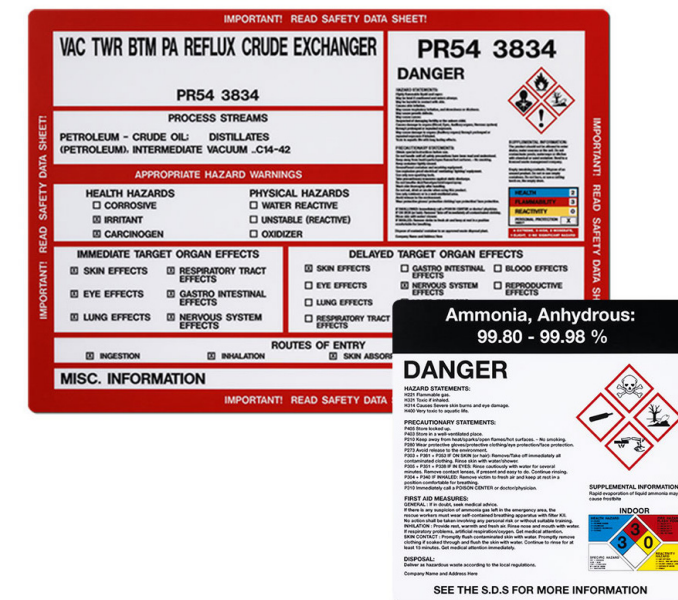

Custom Fence Signage

Custom fence signage is ideal for keeping your construction site safe and informed. Fence signage can be customized to fit your specific needs including custom text, images, and company logos. Contact an MSI rep to learn more.

- Materials include enameled aluminum, MS-215 rigid or flex, engraved plastic, adhesive, reflective and more
- OSHA headers available
- Legends can include operational and safety, PPE warnings, trailer/contractor signs and more
- Custom legends and materials available
- Chain link fence sign bracket available for mounting (pictured upper right)



Part #15744



For Compliance with OSHA Right-to-Know Laws

MS-215 Max-Tek™ Rigid identification signs can help you name and number each tank, vessel or piece of equipment.

- Extremely durable MS-215 Max-Tek™ signs are designed to be printed with the unique name and number of each tank or vessel
- Available with grommets or adhesive
- Flexible signs available
- Excellent outdoor life and chemical resistance
- Available with QR codes
- Size 24" x 12"

Legend	Part #	Health	Fire	Reactivity	Specific Hazard
ALUM	65520	2	0	0	-
BLACK DYE	65522	1	1	1	-
BLACK LIQUOR	65523	2	0	2	-
BLUE DYE	65524	0	0	0	-
CALCIUM CARBONATE	65525	1	0	1	-
CAUSTIC	65526	3	0	1	-
CHLORINE	65527	3	1	0	W
DEFOAMER	65528	1	2	0	-
DIESEL FUEL	65529	0	2	0	-
FUEL OIL	65530	0	2	0	-
GASOLINE	65531	1	3	0	-
GREEN LIQUOR	65532	2	0	2	-
HYDROGEN	65534	3	4	0	-
METHANE	65535	1	4	0	-
METHANOL	65536	1	4	0	-
NITRIC ACID	65537	3	0	1	-
NITROGEN	65538	0	0	0	-
PHOSPHORIC ACID	65540	3	0	2	-
POLYMER	65539	0	0	0	-
PROPANE	65541	1	4	0	-
RED DYE	65542	0	1	0	-
SODA ASH	65543	1	0	0	-
SULFURIC ACID	65544	3	0	1	W
TITANIUM DIOXIDE	65545	0	0	0	-
WHITE LIQUOR	65546	3	0	2	OXY



Scan to view our
Technical Data Sheets!

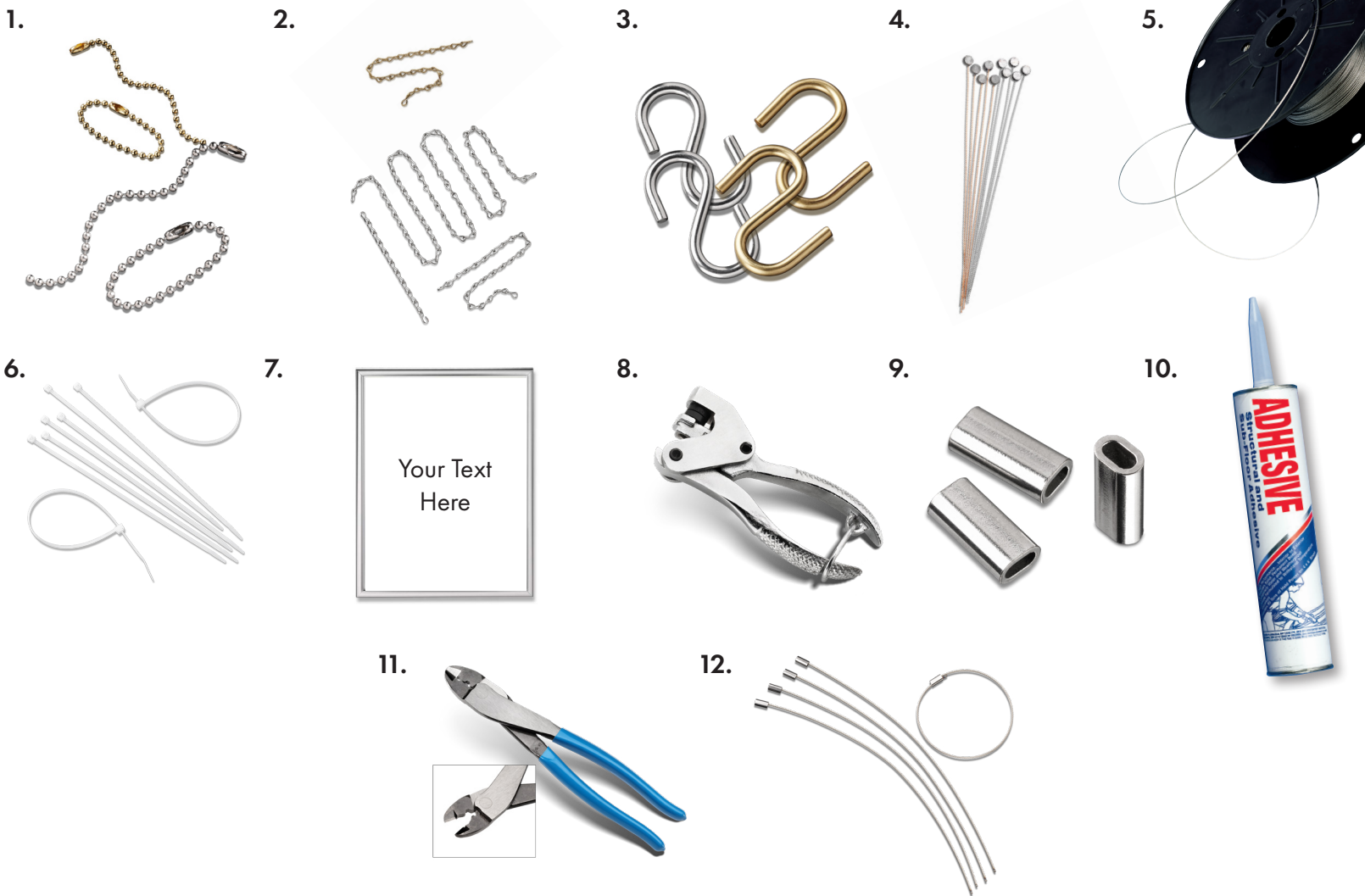

- 1. Bead Chain (Brass & Stainless Steel)**

 - Flexible chain in 4½" lengths including locking link
 - 100 lengths per bag
 - Brass Part #15765
 - Stainless Steel Part #15766
- 2. Jack Chain (Brass & Stainless Steel)**

 - Durable chain for fastening valve tags
 - Packed 50 feet / box to hang approximately 60 tags
 - Brass Part #15760
 - Stainless Steel Part #15761
- 3. "S" Hooks (Brass & Stainless Steel)**

 - Sturdy easy to close hooks for attaching valve tags
 - 100 hooks per bag
 - Brass Part #15770
 - Stainless Steel Part #15767
- 4. Lead Meter Seals (Copper & Stainless Steel)**

 - Fast, permanent way to attach valve tags
 - Supplied in 10" lengths
 - 100 lengths per pack
 - Copper Part #15795
 - Stainless Steel Part #15797
- 5. Stainless Steel Braided Wire**

 - 100' roll
 - Type 316 stainless
 - Part #15747
- 6. 8" Nylon Tag Ties**

 - Simple, quick way to attach valve tags
 - 100 ties per bag
 - Part #15785
- 7. Valve Chart Frame**

 - Aluminum frame holds 8½" x 11" valve chart
 - Durable and easy to install
 - Part #15790 - Plastic Lens
 - Part #15791 - Glass Lens
- 8. Sealing Press**

 - Tool for sealing lead meter seals
 - Part #15796
- 9. Stainless Steel Swage Sleeves**

 - 100 per bag
 - Type 316 stainless
 - Part #15746
- 10. Construction Adhesive**

 - 10.2 oz tube
 - Fits most caulk guns
 - Heavy Duty Part #15769
- 11. Crimp Tool**

 - Crimping tool for 10" wire crimp combo
 - Part #15749
- 12. 10" Wire/Crimp Combo**

 - 10" wire with crimp
 - Part #15750

Industry Specific

MSI offers products to a wide variety of industries. Every product is specifically designed to withstand the typical conditions of the environment within the facility.

1

Electrical Identification

Within the electrical section you will find products of many different materials. Our wide variety of offerings allows you to pick the material that is most suited for the environment in which it will be placed. We have a wide variety of products including cable & conduit markers, arc flash labels, switch plates and more.

2

Fire Identification

Fire identification involves products from our core offerings which are recommended for use in applications involving fire safety processes. Standard colors are white text on red, with custom colors and products available.

3

Ammonia Identification

Facilities utilizing ammonia refrigeration systems are required to implement effective PSM (Process Safety Management), RMP (Risk Management Programs) and mechanical labeling regulatory compliance programs. Labeling of ammonia refrigeration piping, valves and components is a required component of any PSM program. Labeling from MSI is built to withstand the harsh conditions of food & beverage facilities.

Industry specific labeling is designed to help you handle the labeling issues that arise from your specific industry. Our knowledgeable labeling experts know the exact challenges you face in each industry and are well-versed on proven solutions to help you overcome these obstacles.

Plastic & Stainless Steel Switch Plates

Stainless steel and plastic cover plates can be engraved or engraved and color filled providing the ideal option for identifying important circuits such as those connected to emergency backup power.

Mark your cover plates with equipment or lighting information to clearly show what is being controlled. Customized cover plates take the mystery out of your switches by identifying critical electrical information based on your specifications.

- Multiple lines of text available
- Engraving allows for a wide variety of font choices
- Text height is optional (height based on number of characters and available space)
- Any configuration of cover plate
- No minimum quantity
- Quick turnaround to meet your schedule on standard, duplex or quad plate configurations
- For metal engraved plates, our service leaves a tactile finish to the cover plates. In event of fire, plate identification is still legible.
- Economical engraving provides a permanent black legend on plain stainless steel
- We can supply plates or work with your existing ones



Legend Plates for Rotary Switches

Mark all of your controls with these legend plates from Marking Services Inc. for smooth, mistake-free operations. Available in all standard switch configurations. Custom and stock legends are the same price. Plates are made from 1/16" engraved plastic.



Self-Laminating Wire Markers

Self-laminating wrap around wire and terminal markers are premium outdoor grade clear material with an acrylic pressure-sensitive adhesive. They are used to provide branch circuit or feeder numbers for power and lighting circuits and system color-coding. They may be ordered pre-printed and in custom colors including clear.

- Can be pre-printed in custom colors
- Text height based on wire size
- Can be color-coded to meet your marking needs
- Markers come in sheets
- Quantity of markers per sheet dependent on size

DIS202-WIT-004-01

G-IN24 Generator G-4 G-4: First Out

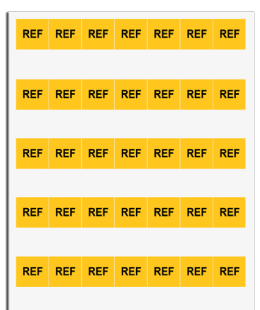

Stainless Steel Cable & Conduit Markers

Engraved type 316 High Performance Stainless Steel strap-on cable markers are designed for the highly corrosive environments of pharmaceutical manufacturing, petrochemical facilities as well as other harsh environments. The text is permanently engraved into stainless steel. Cable markers are strapped on to cable using stainless steel or nylon strapping.



MS-995 Coiled Data Cable & Conduit Markers

Designed to withstand the harshest environments, MS-995 coiled conduit markers from Marking Services Inc. are an excellent choice to identify conduit in harsh indoor or outdoor environments. These coils use color and/or text to communicate important information regarding service, end-user or origin of conduit. Coils are sized to fit completely around the circumference of the conduit and adhere to themselves, making installation more efficient than conventional tapes. Constructed of a polyester film with MS-1000 protective over laminate, these markers provide maximum protection from UV and chemical exposure.

Style	Conduit Diameter	Marker Width	Marker Type
A	Up to 1"	2"	Wrap-Around
B	1" - 2"	2"	Wrap-Around
D	2½" - 4"	2"	Wrap-Around
E	4½" - 6"	2"	Wrap-Around

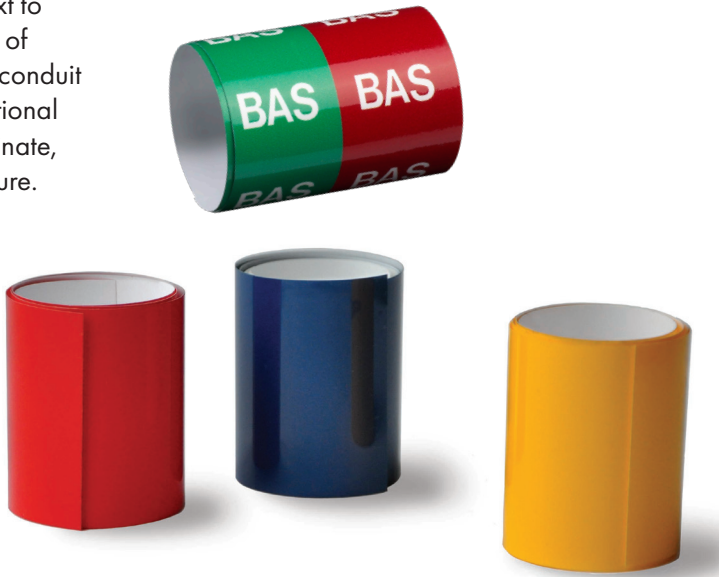

MS-970 Coiled Data Cable & Conduit Markers

Ideal for data centers, MS-970 coiled plastic conduit markers are designed to efficiently and effectively mark, organize and control the complex conduit in place in data transmission, telecommunications, fiber optics, CATV and electrical systems. Semi-rigid coiled markers wrap completely around conduit and remain secure without the use of adhesives. Manufactured in standard 2" width, size of coil is based on the circumference of the conduit. They can be produced with or without text and with multiple color bands in a variety of custom widths. Available in a wide variety of colors and color combinations to accommodate any project specification.

Style	Conduit Diameter	Marker Width	Pieces per Stick
A	½" - 1"	2"	4
B	1⅛" - 2¼"	2"	4
C	2⅜" - 3¼"	2"	6
D	3⅝" - 4½"	2"	6
E	4⅞" - 5⅞"	2"	6



MS-900 Cable & Conduit Markers

MS-900 self-adhesive conduit markers and electrical identification labels from Marking Services Inc. are used to identify a plant's electrical services and equipment.

- Designed for labeling conduit, panel boxes, circuit breakers and connections to equipment
- Black text on orange labels provide a highly visible warning of potential electrical hazards
- Premium MS-900 material insures a durable long lasting indoor marker
- Custom legends available, please request a quote
- Other color combinations available
- NOTE: ½" x 2½" labels are supplied/priced ten markers per sheet



MS-970 Coiled Cable & Conduit ID

Designed to eliminate confusion of tightly packed conduit and cable.

- Markers quickly snap around conduit or cable, clearly identifying voltages or functions
- Indoor use only



*** Use column 5 and the sizing chart for MS-970 markers.**

Stock Legend	MS-900 ½" x 2½"	MS-900 1" x 8"	MS-900 2" x 9"	MS-970 Part #'s
110 VOLTS	70001	71001	72001	9780-
115 VOLTS	70002	71002	72002	9781-
120 VOLTS	70003	71003	72003	9782-
120/208 VOLTS	70004	71004	72004	9783-
208 VOLTS	70005	71005	72005	9784-
220 VOLTS	70006	71006	72006	9785-
230 VOLTS	70007	71007	72007	9786-
240 VOLTS	70008	71008	72008	9787-
277 VOLTS	70010	71010	72010	9788-
277/480 VOLTS	70011	71011	72011	9789-
440 VOLTS	70012	71012	72012	
480 VOLTS	70014	71014	72014	9790-
600 VOLTS	70016	71016	72016	9791-
4160 VOLTS	70026	71026	72026	9792-
CONTROL	70027	71027	72027	9793-
DATA	70028	71028	72028	9794-
FIBER OPTIC CABLE	70029	71029	72029	9795-
FIRE ALARM	70030	71030	72030	9796-
LIGHTING	70017	71017	72017	9797-
POWER	70018	71018	72018	9798-
SECURITY	70025	71025	72025	9799-
SINGLE PHASE	70019	71019	72019	9696-
TELEPHONE	70031	71031	72031	9697-
THREE PHASE	70020	71020	72020	9698-

Style	Diameter
A	½" - 1"
B	1⅛" - 2¼"
C	2⅜" - 3¼"
D	3⅝" - 4½"
E	4⅞" - 5⅞"

Use this chart for MS-970 Part #'s

ORDER MS-970 Pipe Markers

- Determine the four-digit part number for each legend.
- Use the marker style table above to determine appropriate size and add corresponding letter to end of part #
- EXAMPLE: The marker "110 Volts" for 2" diameter would be part number 9780B
- Contact us for custom markers

MS-900 Arc Flash Labels

The MS-900 Self-Adhesive Arc Flash Labels are designed to mark switchboards, panel boards, industrial control panels, meter socket enclosures and motor control centers that require either examination, adjustment, servicing or maintenance while energized. These self-adhesive labels provide electricians and staff with information to maintain plant and worker safety. The labels are made of premium grade material with an acrylic pressure-sensitive adhesive. Labels can be preprinted with custom information (provided by the customer*). *Customer must provide PDF artwork created to size.

- Labels comply with NFPA 70E, NEC Section 110 and OSHA safety standards.
- Available with UV Protective Top Laminate

MS-478 Self-Adhesive Polyester Arc Flash Labels

These premium labels are custom printed with the information and safety header for your specific application. All labels include a safety header and alert symbol. Other information can include incident energy (cal/cm2), hazard category, PPE required and boundary distances. These labels comply with the NFPA, NEC and OSHA requirements.

The printed graphics on these labels are protected against the effects of chemicals and fading caused by ultra-violet rays. Self-adhesive polyester labels are made of pre-printed 2 mil. thick polyester with UV Protective Top Laminate. Labels can be preprinted with custom information (provided by the customer*). *Customer must provide PDF artwork created to size.

MS-478 Electrical Control Panel Labels

MS-478 Electrical Control Panel Labels are chemical and abrasion resistant, extremely durable and ideal for recording equipment information and settings with easy-to-read legends. Our Electrical Control Panel Labels are available in a full range of color and quantity options. Our MS-478 signs are made from 2mil thick polyester with a UV Protective Top Laminate. MS-478 labels are designed for long-term outdoor durability. Labels can be preprinted with custom information.

- Electrically non-conductive engraved plastic available

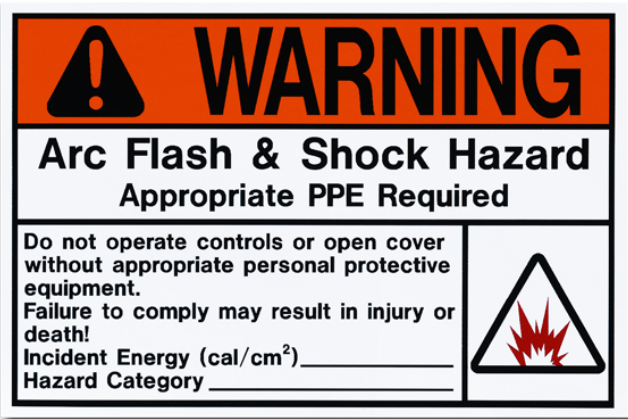
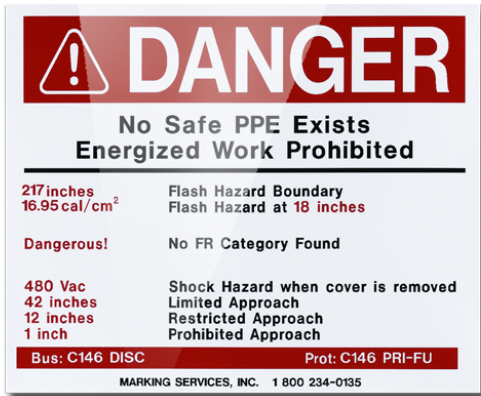

MS-970 Coiled Pipe Markers

MS-970 coiled pipe markers are constructed of semi-rigid material and are designed to identify piping in a wide variety of environments, especially in applications where the pipe surface is rough, oily, or wet. They stay in place on pipes due to the memory of the coiling process, and therefore do not rely on adhesives. Complies with ASME A13.1.

For pipe 6" in diameter and larger, use nylon straps to secure the plastic marker around the pipe (straps included).



Pipe Diameter	Marker Style	Marker Width	Character Height	Marker Type
¼" - ¾"	TM	3"	¼"	coil-on
½" - 1"	A	8"	½"	coil-on
1 ½" - 2 ¼"	B	8"	¾"	coil-on
2 ¾" - 3 ¼"	C	12"	1 ¼"	coil-on
3 ¾" - 4 ½"	D	12"	1 ¼"	coil-on
4 ¾" - 5 ½"	E	12"	1 ¼"	coil-on
6" - 7 ¾"	F	12"	1 ¼"	strap-on
8" - 10"	G	24"	2 ½"	strap-on
over 10"	H	34"	3 ½"	strap-on

Legend	Color	Part #
FIRE PROTECTION WATER	RED	9826
FIRE SPRINKLER WATER	RED	9736

MS-900 Fire Damper & Access Door Markers

Use MS-900 labels to identify the Fire Protection Piping and Fire Damper Access Doors.

- Self-adhesive labels simply adhere to access doors and piping
- Markers can be customized to designate the specific system or zone
- Sizes and colors comply with the NFPA Standard

Legend	Size	Color	Part #
FIRE DAMPER ACCESS DOOR	3" x 3"	RED	67000
FIRE/SMOKE DAMPER ACCESS DOOR	3" x 3"	RED	67001

Legend	Color	1" x 8"	2 ¼" x 13"	4" x 24"
FIRE DAMPER	RED	91433	92433	93433
FIRE/SMOKE DAMPER	RED	91434	92434	93434
FIRE PROTECTION WATER	RED	91142	92142	93142
FIRE SPRINKLER WATER	RED	91143	92143	93143



Valve Tag Identification

MSI's valve tags are available in laser-engraved red anodized aluminum, engraved plastic, MS-215 rigid or 20-gauge brass tags as noted in 3-8.3 of NFPA Standard #13 for valve identification. The tags can be secured with various fasteners (see page 31 for fasteners).



MS-900 Fire Riser & Sprinkler Labels

- Identify each riser to isolate for testing/maintenance
- Install labels at manifolds and major changes in direction
- Highly-visible white on red printing provides quick identification for fire departments or in-house personnel
- Mark branch lines from control valve to isolate branch and eliminate the need to shut down the entire main header
- Self-adhesive

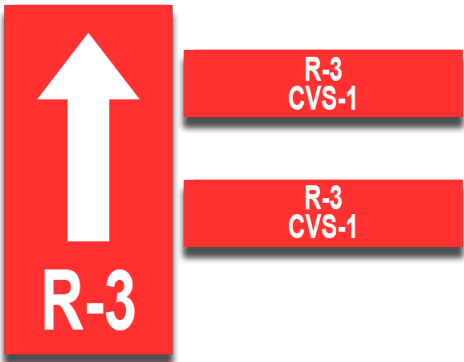

Engraved Plastic Tags & Access Door Signs

- Engraving provides high contrast between letter color and background color for easy visibility
- Standard tags are engraved on 1/16" plastic stock with mounting holes or adhesive backing
- Colors: red with white letters; white with black or red letters
- Various sizes are available



White Enameled Aluminum Fire ID Signs

Aluminum Fire ID signs to identify critical equipment and locations. The enamel background makes an easy to read and aesthetically pleasing equipment sign.

- Available in 5" x 7" | 7" x 10" | 10" x 14" | 14" x 20"
- 4 corner holes for mounting
- .188" hole size
- Custom sizes available upon request



Ammonia Refrigeration Marker Layout



Each marker has five information parts

- Ammonia piping abbreviation section
- Physical State: LIQ (orange or yellow) and/or VAP (Blue)
- Ammonia: black letters on orange or yellow background
- Pressure Level: LOW (70 PSIG or less) = Green
HIGH (greater than 70 PSIG) = Red
- Directional arrow (printed on marker) - scored

SECTION 1 - IIAR Approved Abbreviations [Partial List]

Legend	Abbv
Condenser Drain	CD
Defrost Condensate	DC
Hot Gas Defrost	HGD
High Pressure Liquid	HPL
Highstage Discharge	HSD
High Stage Suction	HSS
High Temp Recirculated Liquid	HTRL
High Temp Recirculated Suction	HTRS
Low Temp Recirculated Liquid	LTRL
Low Temp Recirculated Suction	LTRS
Relief Vent	RV
Thermosyphon Return	TSR
Thermosyphon Supply	TSS

SECTION 2 - Physical State Abbreviation

Liquid	LIQ
Vapor	VAP

SECTION 3 - Ammonia

SECTION 4 - Pressure level abbreviation

Low [70 PSIG and under]	LOW
High [over 70 PSIG]	HIGH

SECTION 5 - Flow Direction Arrow

Left Pointing Arrow	← SCORED
Right Pointing Arrow	→ SCORED

MS-995 Coiled & Carrier Ammonia Markers

MS-995 Pipe Markers are maximum performance pipe markers that stand up to high heat, harsh chemicals and direct exposure to sunlight, which makes them an excellent choice for an ammonia environment.

- Construction provides proven protection from effects of direct sunlight
- Service temperature range from -40° F to 250° F
- Eliminates need for pipe surface preparation
- Pipe Markers can be removed for re-insulation or repainting
- Precoiled pipe markers install easily by wrapping completely around pipe and affixing to themselves [not the pipe surface] with a sealing strip
- Available in Yellow and Safety Orange per the revised IIAR Bulletin 114
- The AMF, AMA, and AM markers consist of a legend label applied to a durable carrier. Markers are attached to larger diameter pipes using stainless steel straps (Pages 7-8). They are designed for easy installation and high visibility on rooftop or elevated piping.

Outside Diameter (Including Insulation)	Marker Style (Orange)	Marker Style (Yellow)	Marker Width (around pipe)	Marker Length (along pipe)
Up to 1 ¼"	AAO	AA	5"	8"
¾" - 2"	ABO	AB	9"	8"
2" - 2 ½"	ACO	AC	12"	12"
2 ¾" - 4 ¾"	ADO	AD	17"	12"
5" - 7.875"	AEO	AE	26"	12"

Outside Diameter (Including Insulation)	Marker Style (Orange)	Marker Style (Yellow)	Carrier Size	Label Height
¾" - 1.875"	AMAO	AMA	2.2" x 10"	1 ½" x 9"
2" - 7.875"	AMFO	AMF	3 ½" x 17"	2 ½" x 16"
8" and up	AMO	AM	5" x 33"	4 ½" x 32"

* Use this chart for carrier markers

Legend	Part #	Abbv	State	Pres
BOOSTER DISCHARGE	3101	BD	VAP	LOW
CONDENSER DRAIN	3102	CD	LIQ	HIGH
DEFROST CONDENSATE	3116	DC	LIQ	HIGH
ECONOMIZER SUCTION	3118	ES	VAP	LOW
EQUALIZER	3117	EQ	VAP	HIGH
FOUL GAS	3119	FG	VAP	LOW
HIGH PRESSURE LIQUID	3104	HPL	LIQ	HIGH
HIGH STATE DISCHARGE	3105	HSD	VAP	HIGH
HIGH STATE SUCTION	3106	HSS	VAP	LOW
HIGH TEMP RECIRCULATED LIQUID	3107	HTRL	LIQ	LOW
HIGH TEMP RECIRCULATED SUCTION	3108	HTRS	LIQ/VAP	LOW
HIGH TEMP SUCTION	3120	HTS	VAP	LOW
HOT GAS	3121	HG	VAP	HIGH
HOT GAS DEFROST	3103	HGD	VAP	HIGH
LIQUID DRAIN	3122	LD	LIQ	LOW
LIQUID INJECTION COOLING	3123	LIC	LIQ	HIGH
LIQUID TRANSFER	3124	LT	LIQ	LOW
LOW STAGE SUCTION	3109	LSS	VAP	LOW
LOW TEMP RECIRCULATED LIQUID	3110	LTRL	LIQ	LOW
LOW TEMP RECIRCULATED SUCTION	3111	LTRS	LIQ/VAP	LOW
LOW TEMP SUCTION	3125	LTS	VAP	LOW
MEDIUM TEMP RECIRCULATED LIQUID	3126	MTRL	LIQ	LOW
MEDIUM TEMP RECIRCULATED SUCTION	3127	MTRS	LIQ/VAP	LOW
MEDIUM TEMP SUCTION	3128	MTS	VAP	LOW
PUMP OUT	3129	PO		
PURGE LINE	3130	PL	VAP	HIGH
RELIEF VENT	3112	RV		
RELIEF VENT	3113	RV	VAP	HIGH
THERMOSYPHON RETURN	3114	TSR	LIQ/VAP	HIGH
THERMOSYPHEN SUPPLY	3115	TSS	LIQ	HIGH



See next page for strapping
* For coated strapping see page 7
* Arrows to be installed separately

Part #	Pipe Diameter	Size
15708	Up to 2 ½"	16"
15705	3" - 4 ¾"	24"
15709	5" - 8"	33"
15714	9" - 12"	46"
15713	13" - 18"	65"

Pre-cut Stainless Steel Straps
Easy to install, cut-to-length stainless steel straps for use with carrier style markers. Durable ¼" wide stainless steel straps come with attached locking clip. Use with locking tool #15716.

Part# 15725



Coiled Stainless Steel Strapping
Easy to install, coil of strapping for use with carrier style markers. Use with locking tool #15716.

Part# 15728



Locking Clips for Strap
Stainless steel clips designed to be used with continuous length strapping. Clips packaged 100 per bag.

Part# 15716



Locking Tool for Strapping
This tool is used to attach stainless steel strapping. The tool can easily cut, tighten, and form a permanent lock.

MS-900 Ammonia Refrigeration Pipe Markers

Indoor application that is ideal for cold-storage areas.

- Adheres well to pipe and insulation with proper surface preparation
- Fast turn-around time with off-the-shelf delivery on standard legends
- Convenient scored arrow eliminates the need to determine flow direction at the time of order
- Self-adhesive
- Available in Yellow and Safety Orange per the revised IIAR Bulletin 114
- Outdoor UV Laminate available (contact rep for details)

Legend	Part #	Abbv	State	Pres
BOOSTER DISCHARGE	3017	BD	VAP	LOW
CONDENSER DRAIN	3001	CD	LIQ	HIGH
DEFROST CONDENSATE	3002	DC	LIQ	HIGH
ECONOMIZER SUCTION	3018	ES	VAP	LOW
EQUALIZER	3003	EQ	VAP	HIGH
FOUL GAS	3019	FG	VAP	LOW
HIGH PRESSURE LIQUID	3005	HPL	LIQ	HIGH
HIGH STATE DISCHARGE	3006	HSD	VAP	HIGH
HIGH STATE SUCTION	3007	HSS	VAP	LOW
HIGH TEMP RECIRCULATED LIQUID	3008	HTRL	LIQ	LOW
HIGH TEMP RECIRCULATED SUCTION	3009	HTRS	LIQ/VAP	LOW
HIGH TEMP SUCTION	3020	HTS	VAP	LOW
HOT GAS	3021	HG	VAP	HIGH
HOT GAS DEFROST	3004	HGD	VAP	HIGH
LIQUID DRAIN	3022	LD	LIQ	LOW
LIQUID INJECTION COOLING	3023	LIC	LIQ	HIGH
LIQUID TRANSFER	3024	LT	LIQ	LOW
LOW STAGE SUCTION	3010	LSS	VAP	LOW
LOW TEMP RECIRCULATED LIQUID	3011	LTRL	LIQ	LOW
LOW TEMP RECIRCULATED SUCTION	3012	LTRS	LIQ/VAP	LOW
LOW TEMP SUCTION	3025	LTS	VAP	LOW
MEDIUM TEMP RECIRCULATED LIQUID	3026	MTRL	LIQ	LOW
MEDIUM TEMP RECIRCULATED SUCTION	3027	MTRS	LIQ/VAP	LOW
MEDIUM TEMP SUCTION	3028	MTS	VAP	LOW
PUMP OUT	3029	PO		
PURGE LINE	3030	PL	VAP	HIGH
RELIEF VENT	3013	RV		
RELIEF VENT	3014	RV	VAP	HIGH
THERMOSYPHON RETURN	3015	TSR	LIQ/VAP	HIGH
THERMOSYPHEN SUPPLY	3016	TSS	LIQ	HIGH

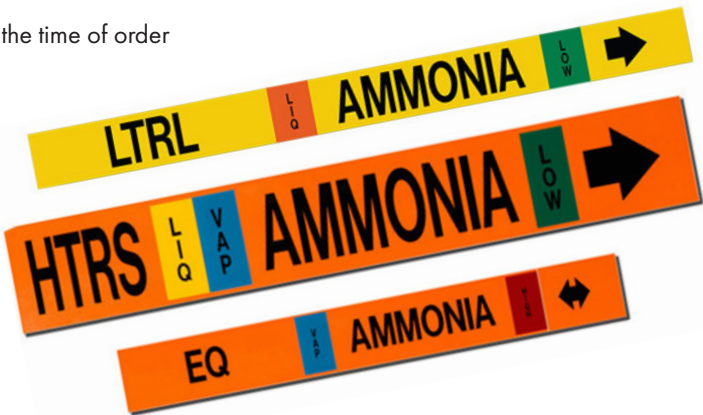

Outside Diameter (Including Insulation)	Marker Style (Orange)
<1 ¼"	A1
1 ½" - 2"	A2
2 ¼" - 7"	A3
8" - 10"	A4
>10"	A5

Outside Diameter (Including Insulation)	Marker Style (Yellow)
<1 ¼"	A1
1 ½" - 2"	AAL
2 ¼" - 7"	ABL
8" - 10"	ACL
>10"	ADL

MS-215 Max-Tek™ Tags

MS-215 tags are constructed of printed legends sealed between two layers of chemically-resistant plastic. This sealed construction offers excellent resistance to chemicals, abrasion and the fading effects of the sun.

- High-performance tags protect the graphics from environmental conditions
- Complete printing flexibility – each unique tag can include multiple lines of text, equipment number, operation and maintenance instructions, safety precautions, or other critical asset information
- Service temperature range: -40 F to 200 F
- Background colors: Yellow, Green, Red, Blue, White, Black or Orange
- Legend Colors: Black or White
- Each rigid tag comes with stainless steel grommets
- Custom colors available
- Custom sizes available
- Double sided tags available
- Photoluminescent material available
- Reflective material available



MS-215 Max-Tek™ Ammonia Information Signs

MSI offers PSM approved ammonia informational signs that can be used as by authorized installation and repair contractors.

- Emergency contact information
- Shut down procedures
- Request custom sliders for frequent text and content changes
- Safety warnings
- System charges

Other products for use in Ammonia Environments

- Custom MS-215 MaxTek™ Equipment Signs (Page 25)
- Engraved Plastic Equipment Signs (Page 26)
- Enameled Aluminum Signs (Page 26)
- Stainless Steel Equipment Tags (Page 25)

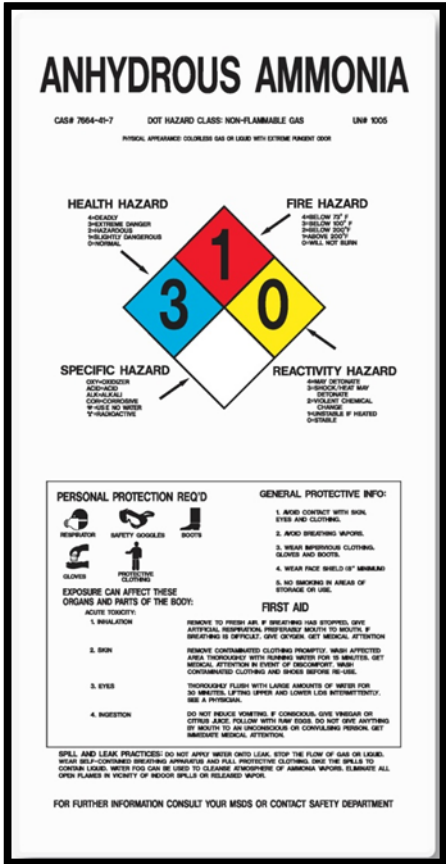

MS-215 Max-Tek™ Ammonia Equipment Identification Signs

Use MS-215 flexible signs to name and number each tank or vessel.

- Extremely durable signs are designed to be printed with the unique name and number of each tank or vessel
- Flexible sign construction allows for easy installation, conforming to the contours of the tank.
- Use heavy duty adhesive to attach sign to tank
- Excellent outdoor life and chemical-resistance



Ammonia Identification Auxiliary/Principal Door Signs

Ammonia identification auxiliary door signs are placed at all entrances to machinery rooms. Our identification signs are specifically designed to provide a clear hazard warning for employees in food processing plants, mills and cold storage facilities.

- Follow ANSI/IIAR 2-2008 standards (including Addendum A) for the identification of piping, valves and components.
- Signs come in standard sizes of 7" x 12" | 6" x 10" | 12" x 12"
- Custom sizes are also available.



Legend Part #
3,3,0 65507
3,1,0 65508



Size Part #
6"x10" 65405
7"x12" 65505



Size Part #
6"x10" 65404
7"x12" 65504



Size Part #
6"x10" 65402
7"x12" 65502



Size Part #
6"x10" 65406
7"x12" 65506



Size Part #
6"x10" 65403
7"x12" 65503



Size Part #
6"x10" 65401
7"x12" 65501



Marking Services Incorporated

CORPORATE HEADQUARTERS

8265 N. Faulkner Road
Milwaukee, Wisconsin 53224
800.234.0135
414.973.1331
sales@markserv.com

DOMESTIC OFFICES

Oregon	800.689.8233
Delaware	302.251.8835
Connecticut	203.263.9828

TECHNICAL DRAFTING

San Angelo, TX

ENGINEERING & INSTALLATION

Baytown, TX

INTERNATIONAL OFFICES

Australia
Canada
United Arab Emirates
Korea
Qatar
Singapore

Scan to see terms & conditions



Scan to visit our Marking
Services Canada website



Scan to visit our Marking
Services Australia website